



Miscellaneous/Local Information

Index

Abstracts	181	Lecture Notes.	183
Audiovisual Equipment (see Speaker Info.)	188	Local Information	183
Banquets/Receptions (see Social Events)	229, 233	Lost and Found	183
Badges/Badge holders	181	Map (hotels)	199
Book Sales and Exhibits	181	Messages	183-184
Check Cashing.	181	Networking Center	184
Child Care	181	Parking	184
Comments and Complaints	181	Petition Table.	184
Committee Meetings	182	Pharmacy	183
Copies/Computer Services.	182	Physically Challenged Participants	184
Directory of Registrants	182	Program at a Glance	185, 211
Email, Internet, and Wireless Access.	182	Programs (replacement)	185
Employment Opportunities	155	Recycling	185
Exhibitors.	201	Registration Desk	185
Exhibitor Special Events	205	Restaurants (with maps).	192
Fax Services	182	Safety When Traveling	185
Floor Plans		Sightseeing/Attractions	186
Marriott Wardman Park.	207	Smoking.	188
Omni Shoreham	210	Social Events	229
Gift for Participants	182	Social Events at a Glance	233
Hotel Information	198	Speaker Information	188
Information Booths (AMS, MAA)	183	Student Information	189
Information Distribution	183	Survey.	189
Joint Meeting Wiki and Blog Sites	183	Travel/Transportation	189
JointMeetingNews	183	Videotaping	191
		Weather	191



Green Efforts at the Joint Mathematics Meetings

In consideration of the shift in global attitudes toward environmental protection, we recognize the importance of contributing to global efforts by adopting eco-friendly practices and making eco-friendly choices at the Joint Mathematics Meetings (JMM).

We are increasing our efforts to make the meetings as environmentally friendly as possible. This is the beginning of an ongoing process with the ultimate goal of a “green” JMM. We are moving toward a future when all aspects of the JMM, including its location, food services, transportation, and the provision of materials will be produced with pollution prevention in mind to reduce our event’s environmental impact. For this meeting we list the following initiatives and goals by suppliers and staff:

1. The **Marriott Wardman Park** has an extensive green program in place that includes
 - Paperless accounting practices within event and front desk operations
 - Cardboard recycling program
 - Unused, reusable food left over from events recycled in staff cafeteria
 - Disposable products only used upon guest request
 - Food items purchased in bulk and prepared in-house from scratch
 - Linen and towel reuse program within all 1,335 guest rooms (approx. 2,088 beds)
 - On-site water and energy saving laundry facility; 10,000 gallon ground water recycle program for lawn irrigation
 - Energy efficient lighting sources used throughout public spaces
 - Sales and administrative offices focused to reduce use of unnecessary paper reporting and reuse paper when ever possible.
 - Paperless communication tools utilized within the hotel
 - Locally grown organic produce or locally raised meat, poultry, and fish (prices and fees will apply)
 - Bulk displays of condiments and or coffee break items and wooden coffee stirrers
 - Beverages by the gallon vs. individually packaged servings (bottles, cans)
 - Biodegradable to go cups and lids
2. The **Hilton Washington** has a policy in place that ensures that they “reduce—reuse—recycle” as much as possible. They maintain recycling units for cardboard, glass, and aluminum cans as part of their daily waste management. Recycling bins are available on all meeting floors for guest use. They also recycle or compost throw-away food waste (vegetable peels, etc).
3. The **Omni** is in the process of developing a green program which may be in operation by January.
4. **Brede Services**, exhibits services provider for this meeting, is providing signs made out of recyclable material and has sent service kits to exhibitors via email as opposed to mailing them.
5. **Taylor & Francis**, a meeting sponsor, is providing meeting bags made of recyclable materials.
6. Our general operations include
 - communicating via e-mail rather than traditional mail or memos,
 - encouraging online registration,
 - making two-sided copies,
 - making every effort to contract with hotels within walking distance of the meeting, and
 - providing collection bins for badges, programs, and other paper waster, along with badge holders, in the registration area.

We also encourage participants to bring personal items to the meeting, where possible, such as coffee mugs and refillable water containers.

We recognize the importance of minimizing the environmental impacts of our meetings. It isn’t possible to do everything all at once; gradual, incremental progress is a worthy goal. But as we continue to incorporate green initiatives in our meetings, we will reduce our environmental impact on a truly meaningful scale. We invite all participants and suppliers to join us in our efforts to make this meeting and our lives more earth friendly.



Abstracts

A booklet containing abstracts all talks presented at this meeting as submitted through the JMM website by the state deadline is available near Advance Registration pickup at the Meetings Registration Desk.



Badges/Badge holders

Any participant who loses or misplaces his/her badge may request a replacement at the Registration Assistance section of the Registration Desk. There is a US\$5 service fee.

If you have no other use for it, please recycle your badge holder in the bins marked for this purpose near the Meetings Registration Desk, by the Directory of Registrants in the Atrium, or next to the two main exits of the Marriott.



Book Sales and Exhibits

The book and educational media exhibits in Halls B and C of the Marriott Wardman Park are open from 12:15 p.m. to 5:30 p.m. on Monday, 9:30 a.m. to 5:30 p.m. on Tuesday and Wednesday, and 9:00 a.m. to 12:00 p.m. on Thursday. Participants are encouraged to visit the exhibits to see what's new. Official meeting badges are required in order to enter the exhibit area. Books published by the AMS and MAA will be sold to registered participants at discounted prices somewhat below the cost for the same books purchased by mail. See the complete list of exhibitors beginning on page 201.

All participants are invited to the **Grand Opening** on Monday at 12:15 p.m. There will be drawings for special prizes or giveaways at participating exhibit booths on Monday afternoon. Join us in making this a special and exciting event.

The AMS and the MAA cordially invite all registered participants to enjoy complimentary tea and coffee available at 12:15 p.m. and 2:00 p.m. on Monday; 9:30 a.m., noon, and 2:00 p.m. on Tuesday and Wednesday; and 9:00 a.m. on Thursday.



Check Cashing

Some hotels will cash personal checks for guests, so check at the front desk of your hotel. The Joint Meetings cashier will cash personal or traveler's checks up to US\$50 upon presentation of the official meeting registration badge, provided there is enough cash on hand. When funds are low, how-

ever, the cashier will not be able to provide this service. The cashier cannot give cash advances on credit cards.



Child Care

The AMS and the MAA will again offer child-care services to registered participants through KiddieCorp Children's Program. These services are for children ages 6 months through 12 years old, January 5-8, 2009, 8:00 a.m.-5:00 p.m. each day in the Marriott Wardman Park. Parents are encouraged to bring snacks and beverages for their children but items such as juice boxes, Cheerios, and crackers will be provided. KiddieCorp can arrange meals for children at cost plus 15% or parents can be responsible for meals for their children.

The registration fee is US\$30 per family (nonrefundable). Additional cost will be US\$10 per hour per child or US\$8 per hour per child for graduate students. These reduced child care rates are made possible to the meetings participants by the AMS and the MAA. Parents must be registered for the JMM to participate. Full payment is due at the time of registration with KiddieCorp. The deadline for registering was December 8, 2008 at www.kiddiecorp.com/jmmkids.htm. Space per day will be limited so walk-ins will be accommodated on a space-available basis only. Check at the Meetings Registration Desk.

If parents do not pick up their children at the time scheduled or by the end of the day (no later than 5:00 p.m.), they will be charged a late fee of US\$5 per child for every 15 minutes thereafter.

On-site fees are payable by cash, check, or credit card.

The concierge or front desk at many of the meetings hotels also maintains listings of child-care providers that they recommend. They suggest calling in late December for their most up-to-date recommendations. Call the hotel and ask for child care recommendations:

Marriott Wardman Park	202-328-2000
Omni Shoreham	202-234-0700
Hilton Washington Hotel	202-483-3000



Comments and Complaints

A log for registering participants' comments or complaints about on all phases of the meeting is kept at the Transparencies section of the Registration Desk. Please use this method of helping us to improve future meetings. (Also see the Survey section.)



Committee Meetings

A master list of all committee meetings is posted on the Directory of Registrants located in the Atrium outside the JMM Exhibits on the exhibition level of the Marriott.



Copies/Computer Services

The Marriott Wardman Park has a Fedex/Kinko's business center located on the mezzanine level of the hotel. The telephone number is 202-986-4028. It is open Monday to Friday, 7:00 a.m to 7:00 p.m., and is accessible 24 hours a day with a Marriott room key. The Omni Shoreham has a business center located on the lobby level, open Monday to Friday from 7:00 a.m. to 8:00 p.m. The Hilton's Summit Business Center is open Monday to Friday from 7:00 a.m. to 7:00 p.m., and on Saturday from 9:00 a.m. to 3:00 p.m.



Directory of Registrants

An alphabetical list of registered participants, including local addresses (if provided) and arrival and departure dates is located in the Atrium outside the Exhibit Hall on the exhibition level of the Marriott Wardman Park. Upon arrival, participants who have registered in advance should place a check mark next to their names. Those who have not supplied information on where they are staying are requested to fill in their information on the printout.

See the information under "Networking Center" for more resources about sorted lists of participants registered in advance.



Email/Internet/Wireless Access



The AMS and MAA are pleased to offer email access for all Joint Meeting participants. This service is sponsored by **Springer** and **Math for America**. The Email Center is located near the Joint Mathematics Meetings Registration Desk on the lobby level of the Marriott Wardman Park.

Free wireless internet access is available in the public areas of the Marriott (this does not include meeting rooms or the exhibit hall). Free wireless internet access is also available in the Omni and Hilton lobby areas.

Meeting participants may access the Internet free of charge in the Marriott by selecting "Connect Code" when they see the splash page at the hotel with either wired or wireless connections, and then entering **Q49XFF** or **TGQ11F**. Either code can be used in the sleeping rooms or public space wireless. For problems, please contact the Marriott's Support Department at 800-571-9462 and identify yourself as a Joint Meeting participant.

The Omni guests can access complimentary internet services their rooms by joining Omni's Select Guest Program. Go to https://ssl.omnihotels.com/sq?pagedst=SG5&long_code=en-us to become a member. This enrollment is free of charge.

Some restaurants in the area offer free wireless access. The closest to the Marriott and Omni is Café International. See the restaurant section for its location.



Employment Opportunities

The Employment Center is located in Exhibit Hall A on the exhibition level in the Marriott. Please see the article on this professional service following the *Program of the Sessions* section on page 155.

The MAA strongly discourages the use of personal hotel sleeping rooms as the site for professional interviews of prospective employees. This practice is intimidating for some job seekers, particularly those who find the situation uncomfortable and possibly unsafe.



FAX Services

FAXes may be received by guests staying at the following hotels at a nominal charge by dialing the numbers below. Be sure to write the guest's name clearly on your fax:

Marriott Wardman Park	202-234-0015
Omni Shoreham	202-265-7972
Hilton Washington	202-232-0438



Gift for Participants

A commemorative tote bag made of recyclable materials is available for all registered mathematicians courtesy of **Taylor & Francis**. Please be sure to stop by their booth in the exhibit area to thank them for providing these handy bags.

To get yours, go to the bag distribution table in the meeting registration area in the Marriott, and turn in the voucher included on your badge/ticket printout.



Information Booths (AMS & MAA)

All participants are invited to visit the AMS and MAA booths in the exhibit area.

A representative is available at each organization's booth to answer questions about membership, publications, and other programs.



Information Distribution

Tables are set up in the exhibit area for the dissemination of general information of possible interest to participants not promoting a product or program for sale.

If a person or group wishes to display information of a mathematical nature promoting a product or program for sale, they may do so at the Joint Books, Journals, and Promotional Materials exhibit for a fee of US\$50 per item (higher for posters).

If a person or group would like to display material in the book sale area separate from the Joint Books table, the proponent must reimburse the meeting for any extra furnishings requested (tables, chairs, easels, etc.) in addition to payment per item. (This latter display is also subject to space availability.)

Please see the Exhibits Manager for details and availability.



JMM Wiki & Blog Sites

To help you plan for and use your time wisely at the meeting, the MAA has set up a wiki (<http://jmm09.pbwiki.com>) that allows participants to access and share information about the meeting and the Washington DC area before and during the meeting. The password for access to editing the site will be published in the daily newsletter. We strongly encourage you to help your fellow participants by contributing information.

Also, share the experiences of math graduate student Adriana Salerno, University of Texas, as she records her summaries of events at the 2009 meeting at www.ams.org/blog/jmm2009. Salerno is a past AMS-AAAS Media Fellow, working for ten weeks as a reporter for Voice of America. Visit the site to read Adriana's impressions of JMM 2009 and contribute some of your own.



Joint Meeting News

This is the official newsletter for the meetings, containing program updates and other important information, and it will be published daily during the meetings. Look for it at the Networking Center, Registration Desk, and at the entrance to the Marriott Ballroom Salons 1 & 2.



Lecture Notes

Participants are welcome to print a copy of the AMS Colloquium Lecture Notes from www.ams.org/amsmtgs/colloq-09.html. In the interest of our "green" initiatives, paper copies of these lecture notes will not be distributed at the meeting.



Local Information

For information about restaurant reservations, grocery stores, pharmacies, laundromats, and other local goods and services, please check at your hotel with the concierge or the front desk, who can best advise you. **Destinations DC** will also provide local information and dining recommendations/reservations during the meeting at a table near the Registration Desk.

Neighborhood Grocery Store: (near Marriott and Omni) **Manhattan Market**, 2647 Connecticut Avenue NW, 986-4774. Open 7:00 a.m. to 11:00 p.m.

CVS Pharmacy: (near the Marriott and Omni) 2616 Connecticut Avenue NW, 202-332-1446. Monday to Friday, 7:00 a.m. to 11:00 p.m., weekends, 8:00 a.m. to 11:00 p.m.

Rite Aid Pharmacy: (near the Hilton), 1815 Connecticut Avenue NW, 202-332-5368. 24 hours.



Lost and Found

See the Joint Meetings cashier.



Message Board

A personal message board is located in the Atrium outside the Exhibit Hall on the exhibition level of the Marriott. Participants will be able to leave messages for other participants and post them alphabetically on a corkboard. Participants may find it more efficient to leave telephone messages for other participants at the appropriate hotel (residences during the meeting are listed on the Directory of Registrants if the participant made

reservations through the Mathematics Meetings Service Bureau). See the hotel page (p. 194) for phone numbers.



Messages (telephone)

The most efficient manner for leaving a telephone message is at the participant's hotel. Messages also will be taken at the Joint Meetings Registration Desk at a telephone number to be published in *Joint Meeting News*. Messages will be recorded from January 5th through 8th during the hours that the Registration Desk is open and posted on the message board. In the case of a bona fide emergency, every attempt will be made to contact the participant as soon as possible; otherwise, each participant must take responsibility for checking the message board.



Networking Center

In the Atrium outside the Exhibits on the exhibition level of the Marriott Wardman Park is an area with tables and chairs for the convenience of those participants who would like to take a break between sessions. Also located in this area are lists of participants sorted by university, and other lists sorted by math subject interest. We hope you will use these materials to find old friends and make new ones.

Newcomers also may want to investigate the many receptions listed in the *Social Events* and *Social Events at a Glance* sections, and the Student Hospitality Center.



Parking

Parking is available at the Marriott Wardman Park for US\$32 per day for self-parking and US\$37 per day for valet parking. There is valet parking available at the Omni Shoreham for US\$28 per day.



Petition Table

At the request of the AMS Committee on Human Rights of Mathematicians, a table is available in the exhibit area at which petitions on behalf of named individual mathematicians suffering from human rights violations may be displayed and signed by meeting participants acting in their individual capacities. See the Program Facilitator/Registration Desk Manager for details.



Physically Challenged Participants

Questions about accessibility of session rooms, public space or problems commuting between the Marriott and Omni should be directed to the Logistics Manager at the Registration Desk. Questions regarding accessibility of housing should be directed to the Registration Assistance section, also at the Desk. For your convenience, we list the following services at the hotels:

1. **Wheelchairs:** The **Marriott** has six wheelchairs on site (no charge for usage). Participants who need a wheelchair should go to the front desk to request it. Wheelchairs are available in the **Omni** to use for traveling throughout the hotel, however, they do not have wheelchairs or scooters that are available for rent for the duration of a guest's stay. Requests to rent a wheelchair at the **Omni** must be made at their Concierge Desk, who will contact an outside vendor on your behalf.

2. **Scooters:** The **Marriott** does not provide scooters. Participants who need a scooter are responsible for making their own arrangements and should contact Julia Williams at 1-866-845-8321 or go to www.thescooterstore.com/locations/state/DC.html. The Marriott will store the scooter at no charge if a participant decides to have it delivered prior to the meeting. Requests to rent a scooter at the **Omni** must be made at their Concierge Desk.

3. **Hearing Impaired Assistance:** The **Marriott** has Williams Hearing Impaired Devices available on site. They are free of charge and consist of three kits that each have a transmitter that connects to the house sound system and a device similar to a hearing aid. Please note that there are a limited number of kits available so participants should make their requests at the front desk as soon as possible. Hearing impaired rooms each consist of a flashing strobe for fire alarm, visual doorbell (when pressed, lights flicker in the room), and message light on the phones (so guests know they have a message). The **Omni** has TTY/TDD machines by request through the hotel operator (limited availability).

4. **Vision Impaired Assistance:** The **Marriott** has the following available for the vision impaired: a) closed caption televisions, b) text telephones, c) visual notification devices for door knocking and telephone rings, and d) Braille writing on all elevators, guest room doors, meeting room signs, etc. Electrical outlets are located next to phone areas for plugging in text telephones. The **Omni** has door knockers and flashers by request (limited availability).

5. Sleeping Rooms/Public Space: The Marriott has a total of 39 hearing impaired rooms, 14 of which are hearing impaired only. The other 25 are for guests who are both hearing impaired and in wheelchairs. The Marriott also offers trained staff on property and accessible ramps throughout entire hotel. The **Omni** has 41 ADA guest rooms in the hotel that offer wider doorways, roll up sinks, bars in bathrooms, lowered closets, lowered peep holes, and roll-in showers (7). The configuration and services in these rooms vary (roll in showers, lowered closets, door bell alert, etc) so guests with a special requirement should be specific about what they need when they make their reservation. In addition, the Omni offers the following: a) lowered counter check-in area, shower chairs by request (limited availability), trained staff on property, a dedicated ADA Elevator, and accessible ramps throughout entire hotel. The Hilton also has guest rooms that are wheelchair accessible and/or meet ADA guidelines.



Program at a Glance

The program at a glance (timetable) is bound into your meeting program. This document provides a thumbnail sketch of all events so you can easily see which events may overlap and better plan your time. If you would like a separate copy, simply ask for one at the Registration Assistance or Transparencies sections of the Meetings Registration Desk. These are available at no charge to registered mathematicians.



Programs (replacement)

Should you lose or misplace your program, replacement copies are available for US\$5 at the Registration Assistance section of the Registration Desk upon presentation of your meeting badge.



Recycling

Please make use of the recycling bins near the JMM registration desk for your unwanted paper (badge inserts, programs, abstracts booklets, other flat paper), and the container at registration for recycling your badge holder. Also see the green initiatives for this meeting and future JMMs on page 180. The Marriott provides recycling containers for other materials, conveniently located throughout the hotel.



Registration Desk

The Registration Desk is located on the lobby level of the Marriott Wardman Park and is open Sunday, 3:00 p.m. to 7:00 p.m.; Monday–Wednesday, 7:30 a.m. to 4:00 p.m.; and Thursday, 7:30 a.m. to 2:00 p.m. Services offered are on-site meeting and MAA minicourse registration, ticket sales for social events, transparency sales, packets for session chairs, registration/housing assistance, abstracts distribution, and audiovisual assistance. Any staff member wearing a blue badge will be happy to assist you.



Safety When Traveling

You are at your most vulnerable when you are away from familiar surroundings. The Destination DC recommends that participants stay in well-lit, well-trafficked areas while enjoying the city.

Never wear your badge outside of the *convention center*.

Thieves employ distraction tactics such as dropping money on the ground or spilling ketchup on you. When you are distracted, your briefcase can be stolen.

Be careful exiting a vehicle, whether car, cab, or bus. Numerous thefts occur at those times. When loading luggage, don't leave belongings unattended, even briefly.

You can be a target when talking on the phone or while waiting for a taxi.

Don't reveal your room number or discuss plans for leaving while in a crowded place—you might be overheard.

If you have valuables on board the plane as carry-on luggage, keep them in view at all times.

Beware of any offer of assistance—to help carry your cases or watch your luggage while you hail a cab.

Beware of a limo driver who offers you a great deal on the ride to the airport. It may be part of a scheme to steal from you. Only use licensed transportation services.

Beware of car trouble while leaving the convention center or driving to the airport. An opportunity for theft arises when the vehicle stops because of a punctured radiator or slashed tire and you tend to the problem—and forget about the luggage.

Ask at the hotel front desk about streets or neighborhoods to be avoided.

Miscellaneous/Local Information

Carry your wallet in your front pocket and your purse with the flap toward you.

Don't travel with a lot of cash. Carry travelers' checks and credit cards.

Always carry the name, address, and phone number of someone to contact in case of an emergency.

Use hotel lock boxes for valuables.

—from Atwood Advantage newsletter, Summer 1996



Sightseeing/Attractions

A few of the many attractions of the nation's capital are listed below. Please note that hours are subject to change. A good source of additional information is the Washington DC tourism website www.washington.org.

Major Government Buildings

The White House, 1600 Pennsylvania Avenue NW, 202-456-7041 (24 hour line). Metro Stop: Metro Center or Federal Triangle. Public tours of the White House are available for groups of 10 or more people. Requests must be submitted through one's Member of Congress and are accepted up to six months in advance. These tours are available from 7:30 a.m. to 12:30 p.m., Tuesday through Saturday, and are scheduled on a first-come, first-served basis approximately one month in advance of the requested date. White House tours are free of charge, but are subject to cancellation, so check the information line listed above the day before your tour date. The White House has a visitor center with interesting exhibits located at the southeast corner of 15th and E Streets. The center is open seven days a week from 7:30 a.m. to 4:00 p.m. More information is available at the White House website www.whitehouse.gov/history/tours/.

United States Capitol Building, Capitol Hill, 202-225-6827, www.aoc.gov/cc/index.cfm. Metro: Union Station or Capitol South. Guided tours of the marble Capitol building are conducted from 9:00 a.m. to 4:30 p.m., Monday to Saturday. If Congress is in session, you may see a live debate! The beautiful grounds around the Capitol were landscaped by Frederick Law Olmstead. Visitors may obtain free tickets for tours on a first-come, first-served basis at the Capitol Guide Service kiosk located along the curving sidewalk southwest of the Capitol (near the intersection of First Street, S.W., and Independence Avenue). Ticket distribution begins at 9:00 a.m. daily.

Supreme Court of the United States, 1st Street & Maryland Avenue NE, 202-479-3211, Metro: Capitol South, Union Station. Open to visitors Monday to Friday, 9:00 a.m. to 4:30 p.m. www.supremecourtus.gov/about/about.html There are lectures in the court every hour on the half hour from 9:30 a.m. to 3:30 p.m. when the court is not in session. There are also exhibits, changed periodically, and a film on the work of the Court.

National Archives, 7th Street & Pennsylvania Avenue NW, 202-501-5000, www.archives.gov/na/visit/. Metro: Archives-Navy Memorial. Open seven days, 10:00 a.m. to 5:30 p.m. The National Archives houses the original Declaration of Independence, Constitution, Bill of Rights and more than three billion records.

Bureau of Engraving & Printing, U.S. Treasury Dept., 14th & C Streets SW, (202) 874-2330, www.moneyfactory.gov/. Open Monday to Friday, public tours begin every 15 minutes, 9:00 a.m. to 10:45 a.m. and 12:30 p.m. to 2:00 p.m. Enter by the Visitor's Entrance on 14th Street. See currency printed at the rate of 8,000 sheets per hour on the self-guided, 35-minute tour. Free, no tickets are required in January, as it is the off-peak season.

Monuments and Memorials

This is just a short selection of some of the better-known monuments.

Lincoln Memorial, West end of the Mall at 23rd Street NW. Open 24 hours a day, rangers on site from 9:30 a.m. to 11:30 p.m. Metro: Foggy Bottom. Truly awe inspiring. Most impressive and dramatic after dark.

Jefferson Memorial, South of the Washington Monument across the tidal basin. Metro: Smithsonian. Open daily from 8:00 a.m. to 11:45 p.m. For more information call 202-426-6841.

Washington Monument, Middle of the Mall at 15th Street NW, 202-426-6841. Open daily from 9:00 a.m. to 5:00 p.m. Metro: Smithsonian. The 555-foot obelisk is visible from nearly everywhere in the city. Ride to the top to see views of the District, Maryland, and Virginia.

Arlington National Cemetery, Virginia side of the Potomac across Memorial Bridge from the Lincoln Memorial. Open 8:00 a.m. to 5:00 p.m. Metro: Arlington Cemetery. Tomb of the Unknown Soldiers, Kennedy graves, Robert E. Lee home.

National World War II Memorial, Completed in 2004, the memorial is located on 17th Street, between Constitution and Independence Avenues, and is flanked by the Washington Monument to the east and the Lincoln Memorial to the west. Metro: Smithsonian. The memorial is open 24 hours a day.

FDR Memorial, 1850 West Basin Drive SW (near the Jefferson Memorial), 202-619-7222. Metro: Smithsonian. This relatively new memorial depicts the years of Franklin Delano Roosevelt's presidency through a series of four outdoor gallery rooms. It features bronze sculptures depicting President and Mrs. Roosevelt and events from the Great Depression and World War II. The park-like setting is quite beautiful and includes waterfalls and quiet pools.

Vietnam Veterans Memorial, Constitution Avenue & Henry Bacon Drive NW, 202-634-1568. Metro: Foggy Bottom. The black granite walls of this moving V-shaped memorial are inscribed with the names of the 58,209 Americans missing or killed in the Vietnam conflict. Frederick Hart's life-size bronze sculpture depicts three young servicemen.

Smithsonian Institution

The Smithsonian is a collection of many museums. Hours are 10:00 a.m. to 5:30 p.m. daily (including weekends) and admission is free. All of the following are on or near the Mall and accessible from the Smithsonian Metro Station. Detailed information about these and all of the Smithsonian museums is at www.si.edu.

Arthur M. Sackler Gallery, 1050 Independence Avenue SW, 202-357-2700. Changing exhibitions of Asian art drawn from major collections around the world, plus Chinese jades, Iranian silver, Persian manuscripts, and contemporary Japanese ceramics.

Freer Gallery of Art (connects underground to the Sackler Gallery), 12th Street & Jefferson Drive SW, 202-357-2700. Outstanding collection of Asian art, plus works by 19th- and 20th-century American artists.

Hirshhorn Museum & Sculpture Garden, 7th Street & Independence Avenue SW, 202-357-2700. Collection of 19th- and 20th-century paintings and sculpture in a striking cylindrical museum and adjoining outdoor garden. Changing exhibitions explore the newest trends in modern art.

National Air & Space Museum, 6th Street & Independence Avenue SW, 202-357-1552. The world's most visited museum houses the Wright Brothers' 1903 Flyer, Lindbergh's Spirit of St. Louis, Apollo 11 lunar command module, and an incredible collection of aviation and space technology treasures. There are admission fees for the IMAX theater presentations and the programs in the Einstein Planetarium.

National Museum of African Art, 950 Independence Ave. SW, 202-357-2700. Devoted to the collection and study of African art.

National Museum of American History, 14th Street & Constitution Avenue NW, 202-357-2700. A wealth of Americana including the flag that inspired The Star-Spangled Banner (now being restored), the first ladies' inaugural gowns, old cars, and big locomotives.

National Museum of the American Indian, 4th St. and Independence Ave., S.W., 202-633-1000. Museum for the preservation, study, and exhibition of the life, languages, literature, history, and arts of Native Americans.

National Museum of Natural History, Constitution Avenue and 10th Street NW, 202-357-2700. Houses the 45.5-carat Hope Diamond, dinosaur fossils, insect zoo, and the world's largest African bush elephant.

National Portrait Gallery, Eighth and F Streets, NW. (202) 633-8300. Paintings, sculptures, prints, drawings and photographs of men and women who have made significant contributions to the history and culture of the United States.

Other Nearby Museums and Attractions

National Gallery of Art on the Mall, Constitution Avenue between 3rd and 7th Streets NW. Open Monday through Saturday from 10:00 a.m. to 5:00 p.m. and Sunday from 11:00 a.m. to 6:00 p.m. Metro: Judiciary Square. One of the world's great collections.

American Art Museum, 8th and F Streets, NW, (202) 633-1000. 11:30 a.m. to 7:00 p.m. daily. Metro: Gallery Place-Chinatown. Dedicated to the art and artists of the United States, part of the Smithsonian, but not located on the mall. The museum's **Renwick Gallery** is located at 1661 Pennsylvania Avenue NW (near the White House), and exhibits American crafts and decorative arts from the nineteenth to twenty-first centuries.

Holocaust Memorial Museum, 100 Raul Wallenberg Place (15th Street) and Independence Avenue SW, 202-488-0400. Metro: Smithsonian. Graphic and moving recreation of the horrors of the Holocaust. Admission is free. More details available at www.ushmm.org

International Spy Museum, 800 F Street SW, 202-393-7798. Metro: Gallery Place/Chinatown. The first and only public museum in the United States solely dedicated to espionage. It features a large collection of spy-related artifacts and stories of individual spies, told through film, interactives, and state-of-the-art exhibits. Adults are US\$18; child, 5-11, US\$15; seniors and military, US\$17. Operation Spy, an "active experience" for ages 12 and up, is US\$14. Phone or check website for hours, generally open every day from 10:00 a.m. to 6:00 p.m.; last admission two hours before closing. www.spymuseum.org.

Miscellaneous/Local Information

Botanic Garden, located on the National Mall across from the U.S. Capitol at 100 Maryland Avenue, SW. Metro: Union Station or Capitol South. The beautiful conservatory is open 10:00 a.m. to 5:00 p.m. daily. Free. www.usbg.gov.

National Zoo, 3001 Connecticut Avenue NW, 202.633.4800. Metro: Woodley Park-Zoo/Adams Morgan or Cleveland Park. The National Zoo is a 163-acre zoological park set amid Rock Creek National Park and is home to 2,000 individual animals of 400 different species. The grounds are open 6:00 a.m. to 6:00 p.m., and the buildings are open 10:30 a.m. to 4:00 p.m. Free. See www.nationalzoo.si.edu/

Tours

There are several tour companies offering dozens of different guided tours in Washington DC. Two companies make regular convenient stops by the meeting hotels.

Grayline Tours makes courtesy stops at the Marriott Wardman Park, the Omni, and the Hilton Washington. Please see the concierge at each hotel for the exact location and times. For a listing of the various DC tours offered by Grayline, and to book tickets, see www.graylinedc.com.

Old Town Trolley Tours makes a stop on Calvert Street between 24th and Connecticut Avenue (for Kalorama/National Zoo/Adams Morgan), close to the Omni Shoreham and the Marriott Wardman Park. Information on Washington DC Historic Tours of America/Old Town Trolley is available at www.historictours.com/washington/, or at 1-800-868-7482 press 7 for Washington DC.

"National Treasure" Tour: While the movie-inspired contest has ended, children and their parents may enjoy planning a tour following the guidelines of the "National Treasure" Tour. See www.washington.org/movies/tour.html.

Performances

The Kennedy Center, 2700 F Street, www.kennedy-center.org/programs/. Metro: Foggy Bottom/George Washington University Station.

The Kennedy Center hosts free performances every day at 6:00 p.m. on the Millennium Stage, check the schedule on the web for details.

To obtain tickets by phone for any of the following three shows, call 1-202-467-4600 or 1-800-444-1324 (10:00 a.m. to 9:00 p.m. daily) or order online at the URL above.

The Music of Andrew Lloyd Webber, until January 4, 2009. This grand showcase of his music features vocalists backed by an on-stage symphony, singing his biggest and most memorable hits. Eisenhower Theater; tickets US\$25-150.

National Symphony Orchestra at the Kennedy Center, January 8-10, 2009. Lynn Harrell performs *Schumann's Cello Concerto in A minor*. Philippe Jordan, in his NSO debut, also conducts Prokofiev's *Classical Symphony* and Beethoven's *Symphony No. 4*. Concert Hall; tickets US\$20-80.

Legally Blonde: the Musical at the Kennedy Center, January 4, 6, 7, and 8. Nominated for seven 2007 Tony Awards, *Legally Blonde* makes its DC premiere. Opera House, tickets US\$25-95.

Shopping

Macy's Metro Center, 1201 G. St. NW. Metro: Metro Center.

The Shops at Georgetown Park, 3222 M. St. NW. Metro: Take the Georgetown Metro Connection shuttle from Dupont Circle. Built in the 1800s, this beautiful Georgetown landmark is home to more than 100 shops and boutiques.

Union Station, 50 Massachusetts Ave. NE. Metro: Union Station. Union Station features more than 130 shops plus a nine-screen movie theatre.



Smoking

There is no smoking allowed in the Marriott Wardman Park Hotel, a smoke-free hotel. Smoking is permitted only outside the main entrance and outside the 24th Street entrance; look for the ashtrays. The Omni Shoreham allows smoking only in a few designated sleeping rooms and outside the building, on each side of the main entrance to the hotel, as well as the Park View entrance (look for the benches and ashtrays). The rest of the hotel is nonsmoking.



Speaker Information

Speakers who cannot present their papers should contact the program coordinator in the AMS office (800-321-4267, ext. 4146). Standard equipment in all session rooms is one overhead projector, a laptop projector (laptops are the responsibility of the speaker), and screen. Invited 50-minute speakers are automatically provided with two overhead projectors and laptop projection. White/blackboards are not available.

Requests for additional equipment made at the meetings most likely will not be granted because of budgetary restrictions. Unfortunately no audiovisual equipment can be provided for committee meetings, other meetings, or gatherings not on the scientific program.

Speakers wishing to prepare transparencies in advance of their talk will find the necessary materials available at a modest charge at the Transparencies section of the Registration Desk.



Student Information

Students may gather in the Student Hospitality/Information Center located in the Atrium outside the Exhibit Hall on the exhibition level of the Marriott. The center will be open 9:00 a.m. to 5:00 p.m. Monday through Wednesday, and 9:00 a.m. to 2:00 p.m. on Thursday.



Survey

Your opinions are important to us! Be sure to fill out the online JMM09 Participant Survey either during the meeting or after. You can access this survey by going to the meetings page at www.ams.org/amsmtgs/2110_intro.html and clicking on SURVEY.



Travel/Transportation

Traveling from the airport: Washington DC is on Eastern Standard Time and is conveniently served by three large airports: Ronald Reagan/Washington National (DCA), Dulles International Airport (IAD), and Baltimore/Washington International Thurgood Marshall Airport (BWI).

Terminal maps of each airport can be found online: Ronald Reagan/Washington National: www.metwashairports.com/reagan/about_reagan_national/directions_maps_reagan/terminal_map_2; Dulles International: www.metwashairports.com/dulles/flight_information_3/terminal_map; Baltimore/Washington International: www.bwiairport.com/customer_assistance/lower_level_terminal_map/.

Driving Directions (to the Marriott/Omni)

From Ronald Reagan Washington National (DCA): The Marriott and the Omni are approximately nine miles northwest of DCA. Leaving the airport, follow the signs to Washington DC northbound along the George Washington Parkway. Take I-395 North to Route 1 (Route 1 is the 14th Street Bridge). Merge to the far left lane on the bridge and follow the signs for 14th Street. Take 14th Street for one mile. Turn left onto K Street. Continue on K for five blocks. Turn right onto Connecticut Ave. and drive about one mile. Cross

over the William Taft Bridge. Turn left onto Calvert St. to the Omni, or continue on and make a left turn at the third light after the bridge onto Woodley Rd. for the Marriott.

From Dulles Airport (IAD): The Marriott and the Omni are approximately 25 miles northeast of IAD. Upon leaving the airport, follow the signs to Interstate 66 east to Washington. Follow I-66 to the Theodore Roosevelt Bridge (U.S. Route 50). Take the Constitution Ave. exit off of the bridge. Continue on Constitution for six blocks and make a left turn onto 17th Street. This will change to Connecticut Ave. Continue on Connecticut Ave. for one mile. Cross over the William Taft Bridge. Turn left onto Calvert St. to the Omni, or continue on and make a left turn at the third light after the bridge onto Woodley Rd. for the Marriott.

From Baltimore/Washington International Thurgood Marshall Airport (BWI): The Marriott and the Omni are approximately 33 miles southwest of BWI. Upon leaving the airport, follow the signs to I-95 South. From I-95 S take I-495 West towards Silver Spring to Exit 33, Connecticut Ave. Southbound. Continue south on Connecticut Avenue for about 6.5 miles. Turn right onto Woodley Rd. for the Marriott or continue on and take a right onto Calvert S. for the Omni.

Taxis and Shuttles

Taxi: One-way taxi fare to the Marriott Wardman Park or to the Omni Shoreham is approximately US\$18–20 from DCA, US\$55 from IAD, and US\$79 from BWI.

SuperShuttle: www.supershuttle.com or 1-800-BLUE VAN (258-3826). Trips can be booked in shared vans, up to seven people. The fares below (current at press time) are from the airport to the Marriott Wardman Park, the Omni Shoreham, or the Hilton.

From DCA: US\$12 for the first person and US\$10 for each additional person in the party. Upon leaving the Baggage Claim area, proceed to the outside curb and contact the SuperShuttle representative. After hours, call 1-800-258-3826 and press 1 for dispatch or 2 for reservations.

From IAD: US\$27 for the first person and US\$10 for each additional person in the party. Proceed to parking and ground transportation curb outside the Baggage Claim area to the SuperShuttle stop. A map showing the shuttle stop can be seen at www.washfly.com/pdfs/ss-map.pdf.

From BWI: US\$36 for the first person, and US\$13 for each additional person in the party. Proceed to the lower level near

Miscellaneous/Local Information

luggage carousels 1-5, Southwest Airlines, in Concourse A or baggage claim 10 in Concourse C to find the ticket counter. After hours, call 888-826-2700.

Public Transportation

Metro (Washington Metropolitan Area Transit Authority, www.wmata.com): The Marriott Wardman Park and the Omni Shoreham are right next to the Woodley Park-Zoo/Adams Morgan Metro Stop on the Red Line. The Hilton is located closer to the Dupont Circle stop, also on the Red Line. The Metrorail (subway) system map can be accessed at www.wmata.com/metrorail/systemmap.cfm. To phone for information on the Metrorail system, call (202) 637-7000; TDD (202) 638-3780.

From DCA: The airport is on the Yellow Line. The metro station is located on Concourse Level 2, accessible from Terminals B and C by enclosed pedestrian bridges. If you arrive at Terminal A, exit the terminal to the street-side curb, and board any Airport Shuttle bus. At the stops for Parking Garages B and C (bus shelter #3 and bus shelter #5) you may access the Metrorail station via an enclosed bridge. Travel on the Yellow Line to Gallery Pl/Chinatown. Change to the Red Line in the direction of Shady Grove to the Woodley Park/Zoo/Adams Morgan stop. Regular fare is around US\$2.55 (discounted fares are available).

From IAD: Purchase a ticket (one-way or round-trip) at the Washington Flyer Coach ticket counter located at Arrivals Door #4 in the Main Terminal and board the coach from this location. The buses depart approximately every 30 minutes, but please listen for announcements for exact bus departure times. The schedule can be accessed at www.washfly.com/flyer_bus_schedule.htm. Ticket prices are US\$10 one way and US\$18 round trip. The Washington Flyer will bring you to the West Falls Church Metro stop on the Orange Line. Trains bound for New Carrollton will take you toward downtown Washington DC. Change at Metro Center to the Red Line. Take the Red Line to Woodley Park or Dupont Circle.

From BWI: It is possible to take the BWI Express Metro Bus Service into Washington DC. (Please refer to www.bwi-airport.com/ground_transportation/washington_dc_wmata/) Metro Bus Service provides a direct connection between BWI and the Greenbelt Metro Station on the Green Line in Washington DC. The fare is approximately US\$7. The BWI Express/B30 service runs every 40 minutes, seven days a week to the Greenbelt Metro Station. Buses run 25 times each weekday and 21 times on Saturday and Sunday, every 40 minutes. There are two WMATA Bus Stops. One is located

on the lower level of the International Concourse and the other stop is located on the lower level of Concourse A/B. The B30 will pick you up outside at the bus shelter. Follow the signs that say "Public Transit".

When you arrive at the Greenbelt Station, take the Green line south and transfer to the Red Line at Gallery Pl-Chinatown to proceed to the Marriott, Omni, or Hilton. For more information call 202-637-7000 or go to www.wmata.com/timetables/md/b30.pdf.

Train from BWI: Rail transportation is available from the BWI Train Station; for details and a map of its location relative to the airport terminal, see www.visitingdc.com/airport/bwi-train-station.htm. MARC trains provide service (Monday to Friday only) to Union Station in Washington DC for US\$6 one way. The MARC route to from BWI to Union Station the Penn Line. The schedule is at www.mtmaryland.com/services/marc/schedulesSystemMaps/penn.cfm.

Amtrak offers daily train service from BWI to Union Station in Washington, DC starting at US\$12 one way. Four routes connect BWI to Union Station (WAS), so Amtrak trains are fairly frequent.

To check possible trains and prices, see www.amtrak.com or call 1-800-USA-RAIL.

From Union Station, transfer to the Metro (subway). The Marriott, Omni, and Hilton are all on the Red line. It is also possible to take a taxi from Union Station.

Discounted Car Rental

Avis Rent A Car is the official car rental company for the meetings. Depending on variables such as location, length of rental, and size of vehicle, Avis will offer participants the best available rate, which can range from 5% to 25% off regular rates. Participants must use the assigned Meeting Avis Discount number (J098887) and meet Avis rate requirements to receive the discount. (Rate discounts are available at all corporate and participating licensee locations.) Reservations can be made by calling 1-800-331-1600 or online at www.avis.com.

All car rentals include unlimited free mileage and are available to renters 25 years and older. Renters must also meet Avis's driver and credit requirements. Return to the same rental location or additional surcharges may apply. Rates do not include any state or local surcharges, tax, optional coverages, or gas refueling charges. At DCA, the rental car counters are located on the first floor of Parking Garage A. To get there, take the "Parking/Rental Car" shuttle, which stops at each terminal outside baggage claim. Club members of each rental car company may proceed directly to the third or fourth floor of Garage A. At IAD, the

rental car companies are located near the baggage claim area on the ground floor of the main terminal. At BWI, the rental car facility is a ten-minute ride from the airport. To get there, take the free shuttle from the lower level terminal outside the baggage claim area.



Videotaping

The videotaping of any Joint Mathematics Meetings sponsored events, including but not limited to Invited Addresses, Colloquia, Minicourses, Special Sessions, Short Courses, Contributed Paper Sessions, and Workshops is strictly forbidden without the explicit written permission of the Director of Meetings. Ask at the Registration Desk.



Weather

January weather in Washington DC can be quite variable. While average daily high and low temperatures are between 42° F and 27° F, it can reach the low 60s during the day when the “January thaw” is evident. However, snowstorms are also possible. Please plan accordingly. Visit your favorite weather site for up-to-the-minute forecasts, or see www.usatoday.com/weather/default.htm.

Where Your Registration Dollars Go

The AMS and MAA make every effort to keep participant expenses at meetings and registration fees for meetings as low as possible. We work hard to negotiate the best hotel rates and to make the best use of your registration dollars to keep the meeting affordable for you. When you pay the registration fee, you are helping to support a wide range of activities associated with planning, organizing, and running a major meeting of this size.

Planning involves such activities as site selection which begins more than five years before the meeting. This encompasses looking for the best hotel and convention center facilities at reasonable rates. The staff also attends to the needs of other organizations, such as the Association for Symbolic Logic, the Association for Women in Mathematics, and the National Association of Mathematicians. Processing over 2000 abstracts and scheduling all sessions, speakers, over 100 committee meetings, and more than 50 social events requires a great deal of precise planning and coordination. These activities along with the production and printing of the meetings program and timetable, the handling of over 4,000 advance registrations, making over 2,000 hotel reservations, preparing badges for advance registrants, and the mailing of advance registration materials are just a part where your registration dollar goes. At the meeting site some of the major expenses are room rental, audiovisual equipment and services, the email center, and support personnel (such as freight handlers and typists).

While the AMS and MAA work hard to make the best use of registration dollars and keep the meetings affordable, your suggestions on how to keep costs down are welcome. While at the meeting please enter your comments in the log at the Transparencies section of the Registration Desk. After the meeting is over, you may forward your suggestions to the Director of Meetings at pop@ams.org.

Restaurant Guide

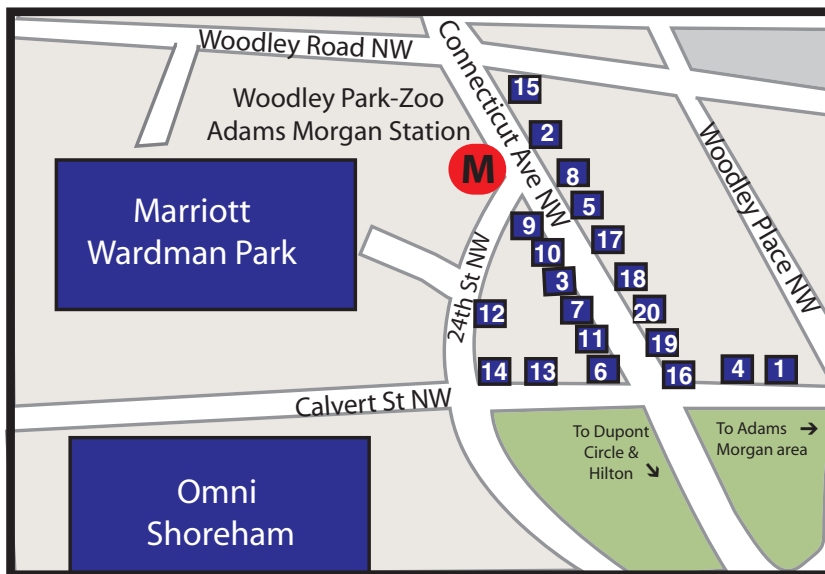

Woodley Park Area Restaurant Map

There is no shortage of restaurants in Washington DC; a few are listed below. **Destinations DC** will provide local information and dining recommendations/reservations at a booth near the Registration Desk during posted hours.

For more information, consult www.zagat.com, or the dining guides at www.washingtonian.com, or www.washington.org. The area code in Washington DC is 202. Hours are subject to change.

Approximate price chart for entrées:	
\$	\$14 and under
\$\$	\$15-\$24
\$\$\$	\$25-\$34
\$\$\$\$	\$35 and up

The Woodley Park area at Connecticut Avenue and Calvert Street near the meeting hotels has a small selection of restaurants. There are many more available as you travel toward Dupont Circle or into Adams Morgan.

Woodley Park Area (see map above)

1. Afghan Grill \$\$

2309 Calvert St. NW, 234-5095. www.afhangrill.com. Open Monday-Saturday, 5:30 p.m.-10:30 p.m. Small Afghan restaurant, kabobs.

2. Café Paradiso \$\$

2649 Connecticut Avenue NW, 265-8955, www.cafeparadisodc.com. Monday-Friday, 11:30 a.m.-3:00 p.m., 5:00 p.m.-11:00 p.m.; Saturday, 11:00 a.m.-11:00 p.m., Sunday, 5:00 p.m.-10:00 p.m. Italian restaurant, mostly pasta and salad; panini at lunchtime.

3. Fusion's Alley \$\$

2608 Connecticut Avenue NW, 986-1010. Cuisine described as Thai/American.

4. House of Philly \$

2311 Calvert St. NW, 265-3500, www.houseofphilly.com. Sunday-Thursday 11:00 a.m.-2:00 a.m., Friday-Saturday 11:00 a.m.-4:00 a.m. Pizza, Italian, takeout available.

5. Café International \$

2633 Connecticut Ave NW, 265-8333. Coffee Shop, sandwiches, wifi.

6. Chipotle Mexican Grill \$

2600 Connecticut Avenue NW, 299-9113. 11:00 a.m.-10:00 p.m. Mexican restaurant.

7. Jandara Restaurant \$

2606 Connecticut Avenue, 387-8876. Sunday-Thursday, 11:30 a.m.-3:00 p.m. and 5:00 p.m.-10:30 p.m. Friday-Saturday,, 5:00 p.m.-11:00 p.m. Local Thai restaurant.

8. Lebanese Taverna Restaurant \$\$

2641 Connecticut Avenue NW, 265-8681, www.lebanesetaverna.com. Hours are slightly different daily, open in general from 12:00 p.m. to 2:30 p.m. and 5:30 p.m.-10:30 p.m. Lebanese, Middle Eastern, Mediterranean food. Well recommended.

9. McDonald's \$

2616 Connecticut Ave NW. (Downstairs in the CVS building)

10. Medaterra \$\$

2614 Connecticut Avenue NW, 797-0400, Monday: 4:00 p.m.-11:00 p.m., Tuesday-Sunday, 10:30 a.m.-11:00 p.m. Mediterranean food; North African influences.

11. Mr. Chen's Organic Chinese Cuisine \$

2604 Connecticut Avenue NW, 797-9668, www.mrchens.com, Monday-Thursday: 11:00 a.m.-10:30 p.m.; Friday-Saturday: 11:00 a.m.-11:00 p.m., Sunday: Noon-10:00 p.m. Chinese, organic vegetables and health-conscious cooking techniques.

12. Murphy's of DC \$

2609 24th St NW, 462-7171. Local bar, Irish pub, traditional bar menu.

13. New Heights \$\$\$

2317 Calvert St. NW, 234-4110, www.newheightsrestaurant.com. Monday-Thursday, 5:30 p.m.-10:00 p.m.; Friday-Saturday: 5:30 p.m.-10:30 p.m. American contemporary cuisine. The "foodie" choice in the immediate neighborhood. Interesting gin bar downstairs.

14. Open City \$\$\$

2331 Calvert St NW, 332-2331, opencitydc.com Monday-Friday, 6:00 a.m.-midnight; Saturday-Sunday, 6:00 a.m.-1:00 a.m. Coffeehouse, diner, bar.

15. Petit Plats \$\$

2653 Connecticut Avenue NW, 518-0018, petitplats.com. Lunch: Monday-Friday, 11:30 a.m.-2:00 p.m.; dinner, Sunday-Thursday, 5:30

p.m.-10:00 p.m.; Friday-Saturday, 5:00 p.m.-11:00 p.m.; brunch: Saturday-Sunday, 11:30 a.m.-3:00 p.m. French bistro.

16. Rajaji Curry House \$\$

2603 Connecticut Avenue NW, 265-7344, www.therajaji.com. Open daily 11:30 a.m.-2:30 p.m.; 5:00 p.m.-11:00 p.m. Indian, curries, tandoori.

17. Sake Club \$\$

2635 Connecticut Avenue NW, 332-2711, www.sakeclub.net. Monday-Thursday, 11:30 a.m.-2:30 p.m. and 5:00 p.m.-10:30 p.m.; Friday-Saturday, 11:30 a.m.-2:30 p.m., 5:00 p.m.-11:00 p.m. Japanese restaurant specializing in sushi.

18. Taste of India \$

2621 Connecticut Avenue NW, 483-1115, toidc.com/. Open daily, 11:00 a.m.-10:00 p.m. Indian restaurant.

19. Tono Sushi \$\$

2605 Connecticut Avenue, 332-7300, www.tono-sushi.com. Lunch, Monday-Friday, 11:30 a.m.-2:30 p.m.; Saturday-Sunday, 12:00 p.m.-3:00 p.m.; dinner: Monday-Sunday, 5:00 p.m.-10:30 p.m. Japanese and Asian restaurant, sushi.

20. Woodley Café \$-\$

2619 Connecticut Avenue NW, 332-5773, www.woodleycafeonline.com/. Monday-Friday: 10:00 a.m.-10:00 p.m., Saturday-Sunday: 9:00 a.m.-10:00 p.m. Traditional American, some Italian food and pizza, full breakfast and brunch.

Near the Zoo/Cleveland Park

One metro stop north of the meeting hotels, about .7 mile up Connecticut Avenue (**off the top of the Woodley Park map**)

21. Ardeo \$\$

3311 Connecticut Avenue NW, 244-6750, ardeorestaurant.com. Monday-Thursday, 5:30 p.m.-10:30 p.m.; Friday-Saturday, 5:30-11:00 p.m.; Sunday, 11:00 a.m.-2:30 p.m. and 5:00 p.m.-10:00 p.m. American contemporary with Asian, Mediterranean, and French elements.

22. Palena \$-\$\$\$

3529 Connecticut Avenue, N.W., 537.9250, www.palenarestaurant.com/. American contemporary. Main menu on the elegant creative side, café menu's burger and made-to-order roast chicken lauded by reviewers. Reservations recommended.



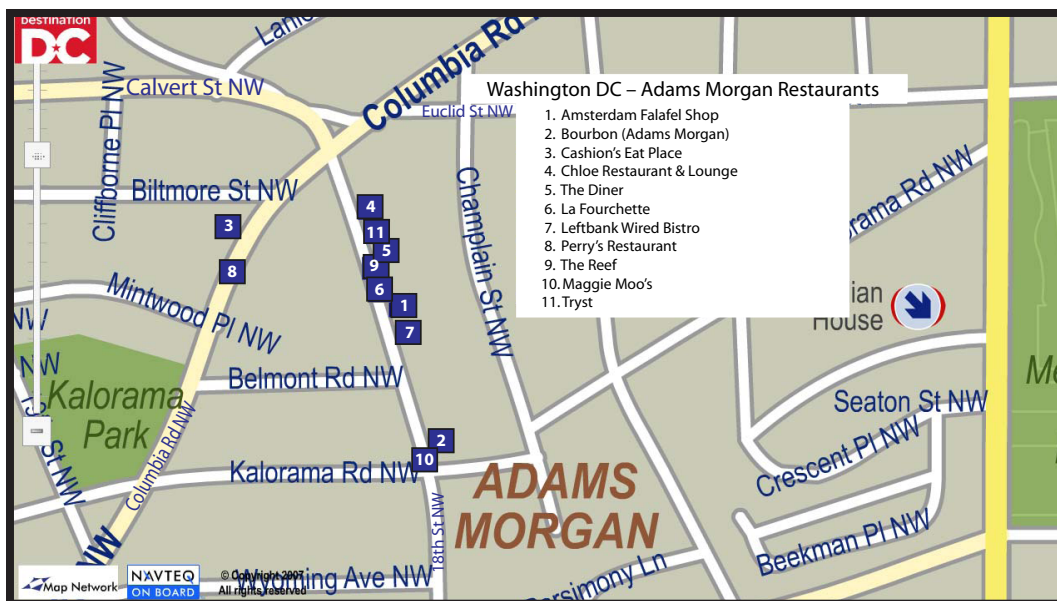

Adams Morgan Area Restaurant Map

Adams Morgan

Approximately .5 mile east of the meeting hotels, a pleasant walk if it is not too cold. This area has a wide variety of moderately priced restaurants. A few are listed below.

- 1. Amsterdam Falafel Shop \$**
2425 18th St NW, 234-1969, www.falafelshop.com/ Open 11:00 a.m. to midnight. Serves falafel/pita sandwiches that you top yourself.
- 2. Bourbon (Adams Morgan) \$**
2321 18th St. NW, 332-0800, www.bourbondc.com. Open weekdays, 6:00 p.m.-2:00 a.m., weekends, 11:30 a.m.-3:00 a.m.; Saturday and Sunday brunch from 11:30 a.m.-4:00 p.m. Food described as upscale comfort food, good microbrewery as well as a collection of bourbons.
- 3. Cashion’s Eat Place \$\$**
1819 Columbia Road NW, 797-1819, www.cashionseatplace.com. Open Tuesday-Sunday, 5:30-10:00 p.m. (11:00 p.m. Wednesday-Saturday) Sunday Brunch: 11:30 a.m.-2:30 p.m. Menu changes depending on market ingredients, New American cooking with French underpinnings.
- 4. Chloe Restaurant & Lounge \$**
2473 18th St. NW, 265-6595, www.chloedc.com. Restaurant/lounge/dance club. Sandwiches, burgers, small selection of entrees.

Washington DC – Adams Morgan Restaurants

- 1. Amsterdam Falafel Shop
- 2. Bourbon (Adams Morgan)
- 3. Cashion’s Eat Place
- 4. Chloe Restaurant & Lounge
- 5. The Diner
- 6. La Fourchette
- 7. Leftbank Wired Bistro
- 8. Perry’s Restaurant
- 9. The Reef
- 10. Maggie Moo’s
- 11. Tryst

- 5. The Diner \$**
2453 18th St. NW, 232-8800, www.trystdc.com. Open 24 hours. Full breakfast all day, modern take on traditional diner food for lunch and dinner.
- 6. La Fourchette \$-\$\$**
2429 18th St. NW, 332-3077. Lunch, Monday-Friday, 11:30 a.m.-4:00 p.m.; dinner, Monday-Thursday, 4:00 p.m.-10:30 p.m.; Friday-Saturday, open until 11:00 p.m.; Sunday, open until 10:00 p.m. Traditional French cooking at moderate prices, not elegant, more like a French country bistro. A family-run place that has been around for years.
- 7. Leftbank Wired Bistro/Lounge \$-\$\$**
2424 18th St. NW, 464-2100, www.leftbankdc.com. Steak, lamb and seafood, sushi bar.
- 8. Perry’s Restaurant \$\$-\$\$\$**
1811 Columbia Road NW, 234-6218, www.perrysadamsmorgan.com. Monday-Thursday, 5:30 p.m.-10:30 p.m. Unusual American with a touch of Asian restaurant and sushi bar, local organic ingredients.
- 9. The Reef \$**
2446 18th St NW, 518-3800, www.thereefdc.com. Sunday, 11:00 a.m.-2:00 a.m.; Monday-Thursday, 5:00 p.m.-2:00 a.m.; Friday-Saturday: 5:00 p.m.-

3:00 a.m. Organic produce, free range meats, environmentally friendly seafood, interesting beers. Salt-water fish tanks.

10. Maggie Moo's \$

2324 18th St. NW, 232-0676, www.maggiemoos.com. Ice cream with mix-ins.

11. Tryst \$

2459 18th St NW, 232-5500, www.trystdc.com. Coffeehouse with internet, owned by same company as the Diner (#5).

**Dupont Circle
(see map on next page)**

One metro stop south of the Marriott and Omni (.9 mile), near the Hilton. There are many good restaurants in this area. A few are listed below.

1. Alero \$

1724 Connecticut Ave. NW, 234-8100, www.alersorestaurant.com. Open daily for lunch and dinner. Local Mexican restaurant chain.

2. Bar Rouge \$

1315 16th St. NW, 232-8000, www.loungedc.com. Sunday-Thursday, 5:00 p.m.-10:30 p.m.; Friday-Saturday, 5:00 p.m.-2:00 a.m. Trendy bar/restaurant at the boutique Hotel Rouge.

3. Brickskellar \$

1523 22nd St. NW, 293-1885, www.love.thebeer.com/brickskellar.html. Sunday, 6:00 p.m.-2:00 a.m.; Monday-Tuesday, 5:00 p.m.-2:00 a.m.; Wednesday-Thursday, 11:30 a.m.-2:00 a.m., Friday, 11:30 a.m.-3:00 a.m.; Saturday, 6:00 p.m.-3:00 a.m. Sandwiches, steak, burgers, award-winning beer selection.

4. Buca di Beppo \$

1825 Connecticut Ave, 232-6580, www.bucadiibeppo.com. Italian restaurant chain.

5. Café at the Phillips Collection \$

1600 21st St. NW, 387-2151, www.phillipscollection.org/. Open Tuesday-Saturday, 10:00 a.m.-4:00 p.m. Sunday, 11-4 p.m. Sandwiches, coffee at art museum.

6. Capital Café \$

At the Hilton, 1919 Connecticut Ave. 483-3000 Open daily. Buffet style dining, different menu every night.

7. Chartwell Grill Restaurant \$-\$

Restaurant of the Churchill Hotel. Open daily 6:30 p.m.-10:30 p.m. American food.

8. Firefly \$-\$

1310 New Hampshire Avenue, NW, www.fireflydc.com. Breakfast, Monday-Friday, 7:00 a.m.-10:00 a.m., Saturday, 8:00 a.m.-10:00 a.m. Lunch, Monday-Friday, 11:30 a.m.-2:30 p.m. Sunday Brunch, 9:00 a.m.-2:00 p.m. Dinner, Sunday-Thursday, 5:30 p.m.-10:00 p.m.; Friday and Saturday, open to 10:30 p.m. Describes itself as an urban neighborhood restaurant, offers contemporary American comfort food.

9. Hank's Oyster Bar \$

1624 Q St NW, 462-4265, www.hanksdc.com/. Features New England beach food such as lobster rolls, clam chowder, steamed mussels, fish and chips. Washington City Paper 2008 "Best of DC" for oysters.

10. Heritage India \$\$

1337 Connecticut Avenue NW. 331-1414, www.heritageindiausa.com/. Recently selected by the Washingtonian as one of the "100 best restaurants in DC". Fine Indian restaurant.

11. I Ricchi \$\$\$

1220 19th St. NW, 835-0459, Monday-Friday, lunch and dinner. Saturday, dinner only. Tuscan restaurant serving steaks and seafood grilled over live oak coals. Fresh homemade pastas.

12. International Marketplace \$

At the Hilton Embassy Row, 2015 Massachusetts Ave. NW, 265-1600. American. Breakfast buffet served 7 days/week. Lunch buffet served Monday-Friday. Dinner is a la carte and ranges from pasta, steak, crab cakes, and hamburgers.

13. Lillies \$

1731 New Hampshire Ave. NW, 349-4440, Restaurant/Bar. Mediterranean food.

14. Luigis \$

1132 19th St. NW, 331-7574, www.famousluigis.com. Monday-Saturday, 11:00 a.m.-12:00 a.m.; Sunday, noon to midnight. Family-run Italian restaurant, famous for its pizza.

15. Marrakesh Palace \$\$\$

2147 P St. NW, 775-1882, www.themarrakeshpalace.com. Moroccan restaurant.

16. M Street Bar and Grill \$-\$\$

St. Gregory Hotel, 2033 M St. NW, 530-3621, www.MStreetBarAndGrill.com. Open for breakfast, lunch and dinner. American, dinner menu includes steak, lamb, salmon, chicken, crab cakes.

17. Odeon Café \$

1714 Connecticut Ave NW 328-6228, www.odeoncafedc.com. Open for lunch, dinner, and brunch. Italian bistro.

18. The Palm \$\$\$

1225 19th St. NW, 293-9091, www.thepalm.com/. Open Monday-Thursday, 11:30 a.m.-10:00 p.m.; Friday, 11:30 a.m.-11:00 p.m.; Saturday-Sunday: 5:30 p.m.-10:00 p.m. Steak house, seafood.

19. Pesce Fish Market and Bistro Café \$\$-\$\$\$

2016 P St. NW, 466-3474, www.pescebistro.com/. Closed on Sunday. Small, cozy restaurant that serves only fresh seafood. Decorated with wooden fish and other fish art.

20. Restaurant Nora \$\$

2132 Florida Ave. NW, 462-5143, www.noras.com. Open Monday-Saturday, 5:30 p.m.-10:00 p.m.; Friday-Saturday, 5:30-10:30 p.m. The country's first certified organic restaurant offers new-American cuisine in Nora's own creative style. Reservations recommended.

21. Ruth's Chris Steak House-Dupont Circle \$\$\$

1801 Connecticut Ave. NW, 797-0033, www.ruthschris.com. Open daily at 5:00 p.m. Famous steak house.

22. Sam & Harry's \$\$\$

1200 19th St. NW, 296-4333, www.samandharrys.com. Monday-Saturday, open at 5:30 p.m. Closed Sunday. Power dining location; classic American steak house.

23. Smith and Wollensky \$\$\$

1112 19th St. NW, 466-1100, www.smithandwollensky.com, Lunch, Monday-Friday, 11:30 a.m.-4:30 p.m.; Saturday, 1:00 p.m.-4:00 p.m. Dinner, Monday-Saturday, 4:30 p.m.-12:00 a.m.; Sunday, 5:00 p.m.-10:00 p.m. Steak, seafood.

24. Stars Bistro and Bar \$\$

2120 P St. NW, 464-6464, www.starsbistro.com. Open daily, 11:30 a.m.-midnight. Singing servers after 7:30 p.m.

25. Taj Mahal Restaurant \$

1327 Connecticut Ave. NW, 659-1544, www.tajmahal1dc.com/. Washington DC's oldest Indian restaurant, serving Tandoori and Muglai delicacies since 1965.

26. The Front Page Restaurant \$

1333 New Hampshire Ave. NW, 296-6500, www.frontpagerestaurant.com/. Open generally from 11:30 a.m. to midnight. American cuisine, with steaks, pastas, seafood featured as well as sandwiches, salads, and baby back ribs. Eleven televisions. Decorated with framed famous front pages.

27. The Melting Pot Restaurant \$\$-\$\$\$

1220 19th St. NW, 857-0777, www.themeltingpot.com. Dinner, Monday-Thursday: 5:00 p.m.-10:00 p.m.; Friday-Saturday to 11:00 p.m., Sunday, 4:00 p.m.-9:00 p.m. Restaurant renowned for its cheese, steak, seafood and decadent chocolate fondues.

28. Topaz Bar \$

1733 N St. NW, 393-3000, www.topazhotel.com. Burgers, appetizers and Asian-influenced specialty plates at bar/restaurant in boutique hotel.

28. Urbana \$\$

2121 P St. NW, 202-956-6650, www.urbanadc.com. Pasta, pizzas from a wood-burning oven, grilled meats and seafood. Wine bar.

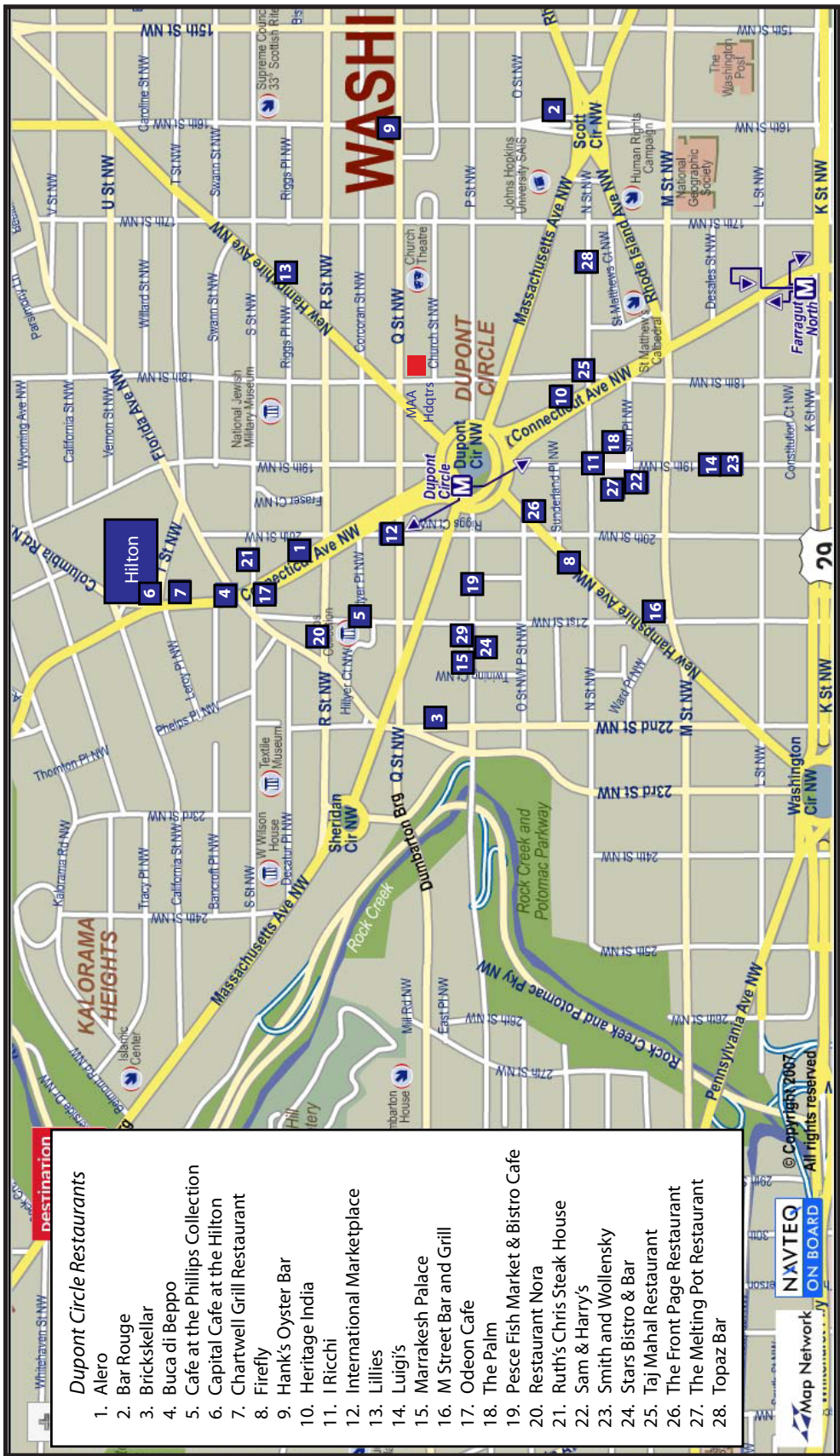

Dupont Circle Area Restaurant Map

Official Hotels of the Joint Mathematics Meetings.

The deadline for making reservations at specially negotiated rates has expired. Participants should call for current rates and availability.

How to Obtain Hotel Accommodations – 2009 JMM		
<p>Complimentary Room Drawing: Anyone who reserves a room at the Marriott, Omni or Hilton through the MMSB by October 31 is eligible for a drawing to have their room reservation made complimentary. See <i>How to Register in Advance</i> for details.</p> <p>Deadlines:</p> <ul style="list-style-type: none"> Complimentary Room Drawing: October 31 Reservations through MMSB: November 14 Changes/Cancellations through MMSB: December 5 <p>Rates:</p> <ul style="list-style-type: none"> Subject to a 14.5% state and local tax Only certified students or unemployed mathematicians qualify for student rates. See <i>Advanced Registration/Housing (ARH) Form</i> for detailed breakdown of rates for each hotel. <p>Guarantee Requirements:</p> <ul style="list-style-type: none"> One night deposit by check, or Credit cards: Visa, MC, AMEX, Diners, and Discover. Hilton charges credit cards one night's deposit immediately. <p>Cancellation Policies:</p> <ul style="list-style-type: none"> Marriott: 7 days before arrival Omni: 48 hours before arrival Hilton: 72 hours before arrival; US \$50 early departure fee 	<p>General Instructions: Participants must register in advance in order to obtain hotel accommodations through the Mathematics Meetings Service Bureau (MMSB). Special rates have been negotiated exclusively for this meeting at the following hotels. Reservations must be made through the MMSB to receive these rates. These hotels should ONLY start accepting reservations directly after December 14, at which time rooms and rates will be based on availability. Higher rates will be applied to any rooms reserved directly with these hotels at the JMM rates before December 12.</p> <p>To make a reservation, please submit a completed housing section of the Advance Registration/Housing Form (ARH) Form (paper or internet) with a guarantee by November 14. Sorry, reservations cannot be taken by phone. The internet form can be found at www.ams.org/meetreg?metnum=2110. The paper form can be found at the back of this announcement. Participants interested in suites should contact the MMSB directly at mmsb@ams.org or 1-800-321-4267 ext. 4143 or 4144 for further information.</p> <p>General Information:</p> <ul style="list-style-type: none"> Check-in at all hotels is 3:00 p.m. Check-out is 12:00 p.m. at the Marriott & Omni and 11:00 a.m. at the Hilton. Windows open in the Omni and Hilton and a little in the Marriott. Children under 18 years old free in all hotels if they are in a room with an adult. Cribs are free of charge (limited availability). The Omni does not permit cribs in rooms that have two beds. The Omni and the Hilton have environmental policies regarding linen, and the Marriott is all "green". Internet Access/Wireless: Marriott: Complimentary wired internet in guest rooms, complimentary wireless in public areas. Omni: Complimentary Wi-Fi service in guest rooms for members of Omni's Select Guest Program (otherwise US \$10 per day), complimentary high speed wireless in the lobby. Hilton: Internet access (wired) US \$12.95/day. Go to https://ssl.omnihotels.com/sg/?pageid=SG5&lang_code=en-us to become a member of Omni's Select Guest Program. This service is free of charge. All hotels are in acceptable compliance with ADA and have TDD phones on premises. Marriott also has a TTY text phone. The Omni will not send separate hotel confirmations. You may contact the MMSB after December 15 if you would like your confirmation number. 	<p>Marriott Wardman Park Hotel (co-headquarters)</p> <p>2660 Woodley Road NW Washington, DC 20008 202-328-2000 Single/Double: US \$150 Student Single/Double: US \$120</p> <p>All nonsmoking hotel; Restaurants; Lounge; Starbucks; Gourmet Deli. Fitness center; Business center; Full amenities in guest rooms; Complimentary wired internet access in guest rooms; Complimentary wireless in public areas; Pets allowed with US \$50 non-refundable fee; Valet parking US \$37 per day; Self parking US \$32 per day. Credit cards will not be charged in advance. Confirmations sent by email only.</p>
<p>Omni Shoreham Hotel (co-headquarters)</p> <p>2500 Calvert St. NW (at Connecticut Avenue) Washington, DC 20008 202-234-0700 Single/Double: US \$150 Student Single/Double: US \$120</p> <p>Restaurants; Lounge; Fitness center (US \$10 per day or US \$18 per person per stay); Business center; Full amenities in guest rooms; Complimentary Wi-Fi service in guest rooms for members of Omni's Select Guest Program (otherwise US \$10 per day); Complimentary high speed wireless internet access in lobby; Pets allowed with US \$50 non-refundable fee; Valet parking including in/out privileges US \$28 per day. Credit cards will not be charged until check-out. Confirmations not sent.</p>	<p>Hilton Washington Hotel (3/4 mile from the Marriott Wardman Park 4 blocks from Dupont Circle Metro Station)</p> <p>1919 Connecticut Avenue NW Washington, DC 20009 202-483-3000 Hilton Rate 1 Single/Double: US \$109 Hilton Rate 2 Single/Double: US \$119</p> <p>Restaurants; Lounge; Deli; Fitness center; Business center; Full amenities in guest rooms; Wired internet access in guest rooms for US \$12.95 per day; Complimentary wireless in the lobby lounge; Self-parking US \$23 per day. Credit cards are charged one night's deposit as soon as reservation is sent to hotel. Changes to departure dates must be made no later than check-in or a US \$50 fee will be charged. Confirmations sent by email only.</p>	

Area Map

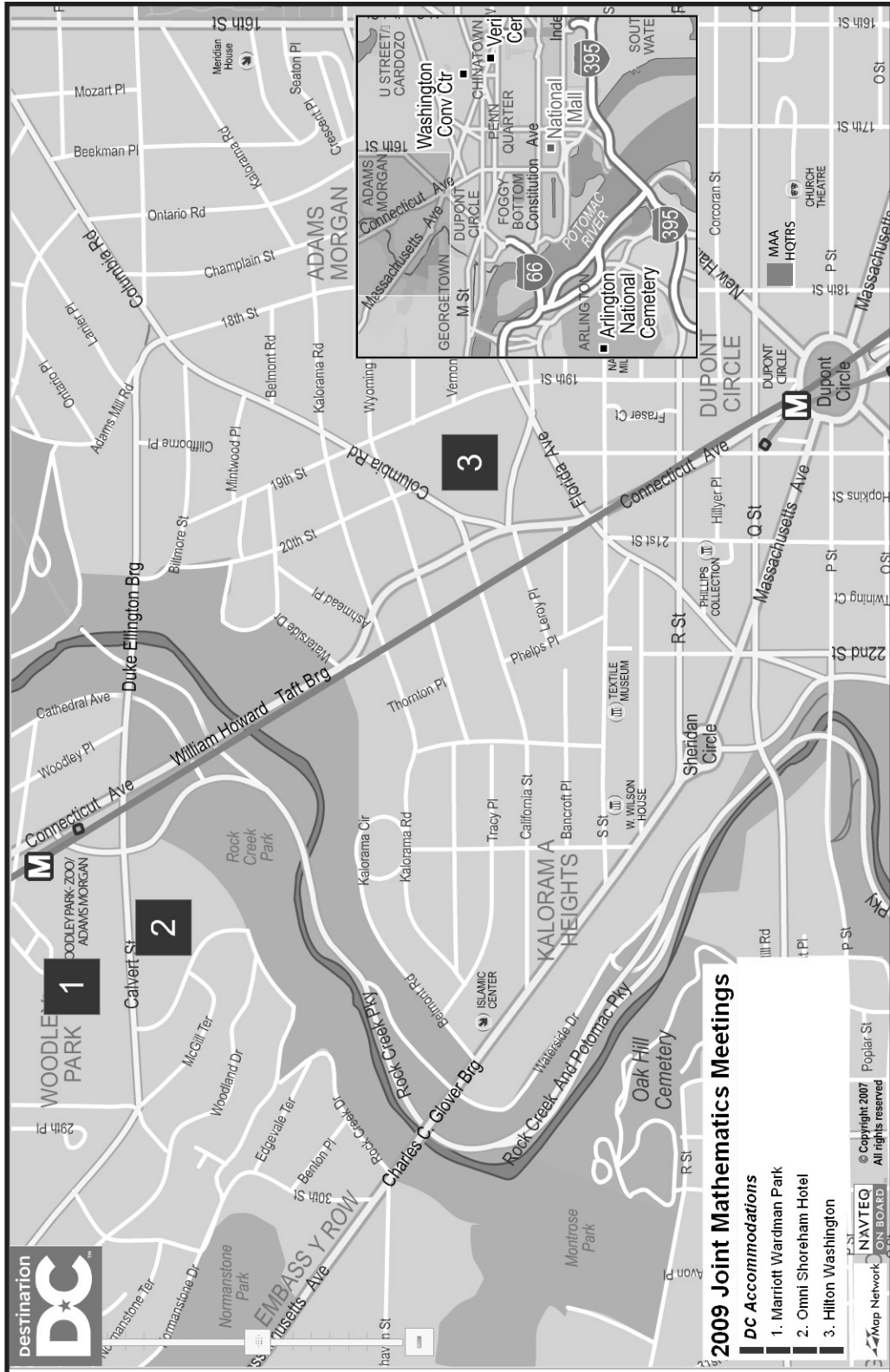

JOINT MATHEMATICS MEETINGS EXHIBITS

MARRIOTT WARDMAN PARK HALLS B & C

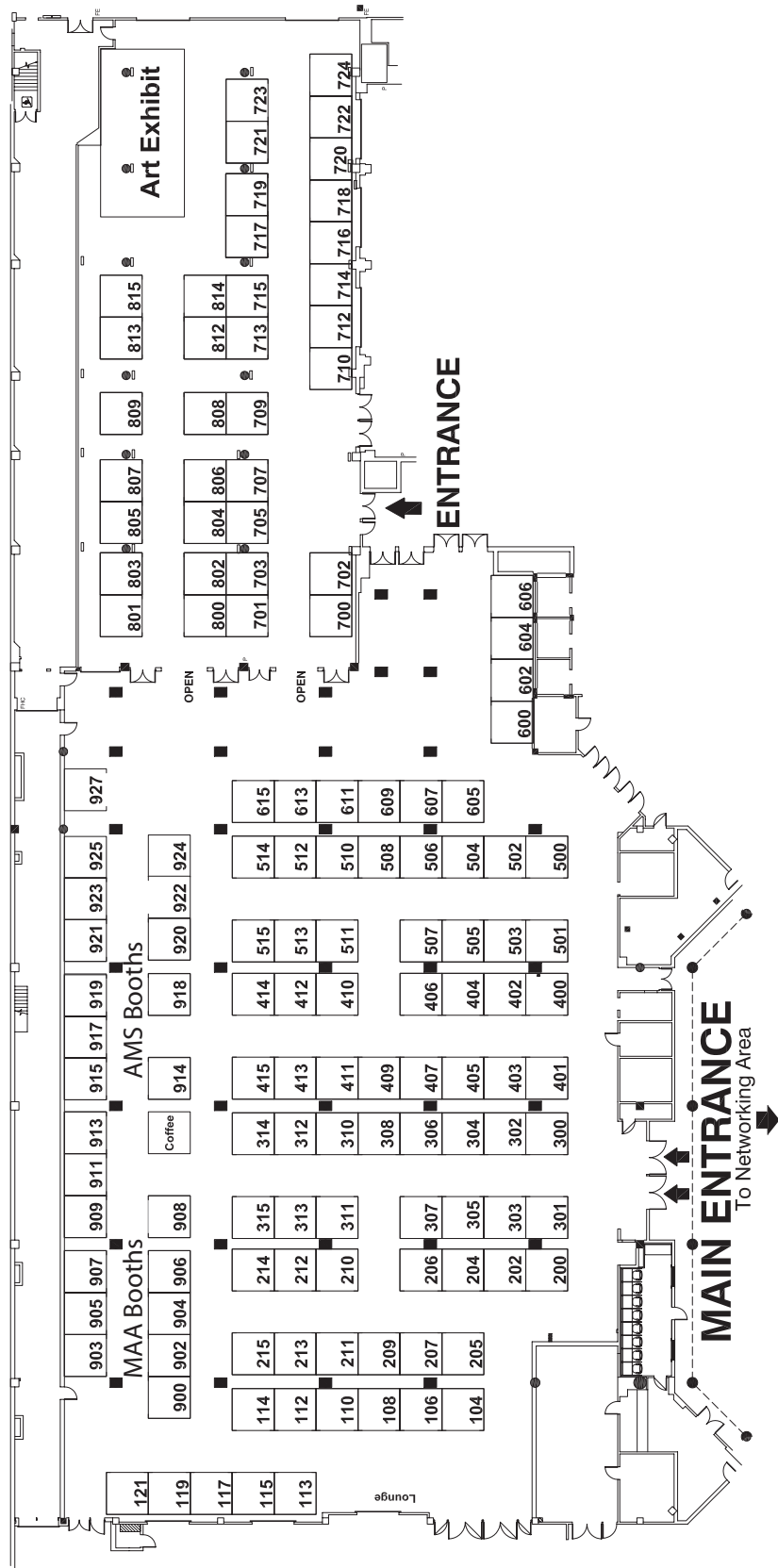



List of Exhibitors

Join us for the Grand Opening of the
 Joint Mathematics Meetings Exhibits on Monday at 12:15 p.m.
 for prizes and giveaways!

ACTEX Publications
 107 Groppo Dr, Suite A
 PO Box 974
 Winsted, CT 06098
Booth 514

AK Peters Ltd
 888 Worcester St, Ste 230
 Wellesley, MA 02482
Booths 402, 404

**American Institute of
 Mathematics**
 360 Portage Ave
 Palo Alto, CA 94306
Booth 114

American Math Competitions
 Mathematics Assn of America
 1529 18th St NW
 Washington, DC 20036
Booth 902 (part of MAA)

**American Mathematical
 Society**
 201 Charles St
 Providence, RI 02904
Booths 914-915, 917-925, 927

**American Statistical
 Association**
 732 North Washington St

Alexandria, VA 22314
Booth 409

Art Exhibit
Exhibit Hall

**Association of Christians in
 the Mathematical Sciences**
 Wheaton College
 Dept of Math
 Wheaton, IL 60187
Booth 121

**Association for Women in
 Mathematics**
 11240 Waples Mill Rd, Ste 200
 Fairfax, VA 22030
Table

Author Resource Center
Booth 914 (part of AMS)

Birkhäuser
 233 Spring St
 New York, NY 10013
Booths 204, 206

**Brooks/Cole, Cengage
 Learning**
 10 Davis Dr
 Belmont, CA 94002
Booths 308, 310, 312, 314

**Budapest Semesters in
 Mathematics**
 12152 Cabot Ave
 Dundos, MN 55019
Table

Bulatov Abstract Creations
 2970 Christine St
 Corvallis, OR 97330
Booth 119

Cambridge University Press
 32 Avenue of the Americas
 New York, NY 10013-2473
Booths 210, 212, 214

Casio America, Inc.
 570 Mt. Pleasant Ave
 Dover, NJ 07801
Booth 718

**Center for Undergraduate
 Research in Mathematics
 (CURM)**
 Brigham Young University
 Dept of Math
 Provo, UT 84602
Booth 115

Dover Publications, Inc.
 31 East 2nd St
 Mineola, NY 11501
Booth 606



Exhibitors

Duke University Press
Box 90660
Durham, NC 27708-0660
Booth 305

Elsevier
360 Park Ave South
New York, NY 10010
Booths 410, 412, 414

**European Mathematical Society
Publishing House**

**Seminar for Applied
Mathematics**
ETH-Zentrum FLI C4
Fliedlerstrasse 23, CH-8092
Zurich, Switzerland
Booth 202

Fit to a Tee
The Shops at Georgetown Park
Washington, DC 20007
Booth 724

Glass & Geometry
325 Breed Rd
Harrisville, NH 03450
Booth 808

Green Lion Press
1611 Camino Cruz Bianca
Santa Fe, NM 87505
Booth 806

Happy Feet
6130 W. Flamingo Rd, PMB 460
Las Vegas, NV 89103
Booth 801

Hawkes Learning Systems
1023 Wappoo Rd, Suite A6
Charleston, SC 29407
Booths 506, 508, 510

Helaman Ferguson, Sculptor
10512 Pilla Terra Court
Laurel, MD 20723
Booth 702

**Institute for Mathematics &
Education**

University of Arizona
617 N Santa Rita Ave
PO Box 210089
Tucson, AZ 85721
Booth 712

IOP Publishing
150 S Independence Mall .
Philadelphia, PA 19106
Booth 800

JEM Thematic Network
Dept of Math & Statistics
PO Box 68
FI-00014 University of Helsinki
Finland
Booth 710

**The Johns Hopkins University
Press**
2715 North Charles St
Baltimore, MD 21218
Booth 215

Joint Books & Journals Table

Jones & Bartlett Publishers
40 Tall Pine Dr
Sudbury, MA 01776
Booths 605, 607

Kadon Enterprises, Inc.
1227 Lorene Dr, Ste 16
Pasadena, MD 21122
Booth 700

Kappa Mu Epsilon
University of Central Missouri
Dept of Math & CS
Warrensburg, MO 64093
Booth 714

**Mathematical Association of
America-Publications**
1529 18th St NW
Washington, DC 20036
**Booths 903,905,907,909,
911, 913**

MAA-Development
1529 18th St NW
Washington, DC 20036
Booth 900

MAA-Membership
1529 18th St NW
Washington, DC 20036
Booths 904, 906

MacKichan Software
19307 8th Ave, Suite C
Poulsbo, WA 98370
Booth 301, 303

Maplesoft
615 Kumpf Dr
Waterloo, Ontario, Canada
N2V 1K8
Booths 609, 611

MASS Program
111 McAllister
University Park, PA 16802
Booth 703

Math for America
50 Broadway, 23rd Floor
New York, NY 10004
Booth 602

Matrix Editions
214 University Ave
Ithaca, NY 14850
Booth 117

Math Alive & Applied
104 Easterly Terr
DeWitt, NY 13214
Booth 705

MathType by Design Science
140 Pine Ave, 4th Floor
Long Beach, CA 90802
Booth 307

McGraw-Hill Higher Education
Two Penn Plaza, 20th Floor
New York, NY 10121-2298
Booths 505-507

Michael Cherry
105 Conway St
Carlisle, PA 17013
Booth 809

Minitab Inc.
Quality Plaza
1829 Pine Hall Rd
State College, PA 16801
Booth 108

National Science Foundation
Div of Mathematical Sciences
4201 Wilson Blvd, Rm 1025
Arlington, VA 22230
Booths 110 & 112

National Security Agency
MB, Suite 6779
PO Box 1661
Ft. Meade, MD 20755-6779
Booths 104 & 106

Nat's Knots
29 Northgate Drive
Albany, NY 12203
Booth 812

Navajo Jewelry & Crafts
2904 18th St NW
Albuquerque, NM 87104
Booth 713

Oxford University Press
198 Madison Ave
New York, NY 10016
Booths 304-306

Pearson
1 Lake St
Upper Saddle River, NJ 07458
Booths 401, 403, 405, 407

Personal TeX, Inc.
725 Greenwich St, Ste 210
San Francisco, CA 94133
Booth 701

Pi Mu Epsilon
Academic Affairs
Hendrix College
1600 Washington
Conway, AR 72032
Booth 709

Powell's Technical Books
33 NW Park Ave
Portland, OR 97209
Booth 604

Princeton University Press
41 William St
Princeton, NJ 08540
Booth 500-502

Project NExT
1529 18th St
Washington, DC 20036
Booth 908 (part of MAA)

**Sage Free Open Source
Mathematical Software**
Univ of Washington
Dept of Mathematics
Box 354350
Seattle, WA 98195-4350
Booth 715

**SAS Institute Inc.,
JMP Division**
100 SAS Campus Dr
Cary, NC 27513
Booth 802

**Elementary Mathematics
for Teachers:**
Instructor Resources
5812 North Shore Dr
Baton Rouge, LA 70817
Booth 717

**Society for Industrial &
Applied Mathematics**
3600 Market St, 6th Floor
Philadelphia, PA 19104
Booths 411, 413, 415

Society of Actuaries
475 N. Martingald Rd, Ste 600
Schaumburg, IL 60173
Booth 512

Springer
233 Spring St
New York, NY 10013
Booths 205, 207, 209, 211, 213

**Taylor & Francis Group LLC-
CRC Press**
6000 Broken Sound
Parkway NW
Boca Raton, FL 33487
Booths 311, 313, 315

Tessellations
3913 E. Bronco Tr
Phoenix, AZ 85044
Booth 815

Texas Instruments Inc.
POB 650311
M/S 3919
Dallas, TX 75265
Booths 501, 503

TeX Users Group
PO Box 2311
Portland, OR 97208-2311
Booth 914 (part of AMS)

**The Educational Advancement
Foundation**
2303 Rio Grande
Austin, TX 78705
Booth 615

ThinkFun, Inc.
1321 Cameron St
Alexandria, VA 22314
Booth 716

University of Tulsa
800 S. Tucker Dr
Helmerich Hall 118-G
Tulsa, OK 74104
Booth 804

Exhibitors

Walter de Gruyter, Inc.
545 8th Ave., Suite 1650
New York, NY 10018
Booth 406

Wholemovement Geometry
4606 North Elston #3
Chicago, IL 60630
Booth 707

World Scientific Publishing Co.
27 Warren St., Ste 401-402
Hackensack, NJ 07601
Booth 504

WebAssign
1730 Varsity Drive., Suite 200
Raleigh, NC 27606
Booth 400

Wiley
111 River St 4-02
Hoboken, NJ 07030
Booth 511, 513, 515

xyAlgebra
110 Riverside Dr #14C
New York, NY 10024
Booth 113

W.H. Freeman
c/o Bedford, Freeman & Worth
33 Irving Place
New York, NY 10003
Booths 300, 302

Wolfram Research
100 Trade Center Drive
Champaign, IL 61820
Booth 200

Ymir Inc-The Ultimate Puzzle
P.O. Box 451421
Los Angeles, CA 90045
Booth 600

Please join us in thanking these
long term exhibitors:

Jones and Bartlett - 20 Years

Maplesoft - 20 Years

National Security Agency - 20 Years

Texas Instruments - 20 Years

Actex Publications - 15 Years

Mathtype/Design Science - 15 Years

The Educational Advancement Foundation - 10 Years

Glass and Geometry - 5 Years

Hawkes Learning - 5 Years

TeX Users Group - 5 Years

Wholemovement Geometry - 5 Years

for their support of the
Joint Mathematics Meetings

Exhibitor Special Event Announcements

✱ ACTEX Publications, Booth 514

Raffle: ACTEX Publications will be have a raffle to give away any two ACTEX Publications textbooks, study manuals or DVD's of the winner's choice. Please visit our booth at any time during the Exhibit hours and sign up to win! Winner will be chosen at close of exhibits on Thursday and will be notified at a later date.

✱ American Mathematical Society, Booth 915-925

Meet and Greet: Meet the *Notices* Editors and editorial board members at an informal event in the AMS Exhibit Area Tuesday, from 11:00 a.m. to 1:00 p.m. Find out more about the *Notices* and how it operates. Give us your feedback; tell us what you would like to see in future *Notices* and get information on how to submit an article. Free gift for all attendees.

Reception: Wednesday. Celebrate 100 volumes of the *Graduate Studies in Mathematics* (GSM) series! Join us for refreshments as we celebrate this event. Enter to win prizes, check out the latest GSM volumes, and take advantage of our JMM specials and discounts.

✱ Cambridge University Press, Booth 210

Raffle: On Tuesday and Wednesday Cambridge University Press will be holding a daily free raffle. Winners will be chosen each day at 5:00 p.m. Cambridge University Press will begin accepting business cards or raffle forms at 12:15 p.m. on Monday. Prizes include various books.

✱ Hawkes Learning Systems, Booth 506, 508, 510

Raffle and Demonstration: Visit the Hawkes Learning Systems booth on any time from Tuesday through Thursday, watch a quick software demonstration, and be entered to win a GPS system! There will be daily drawings for all who attend the demonstrations! Winners will be selected at the close of Exhibits each day.

Reception: Stop by the Hawkes Learning Booth for Complimentary Refreshments on Tuesday, January 6th at 2:00 p.m.

✱ Kadon Enterprises, Inc., Booth 700

Demonstration and Competition: See the World Premiere of Kadon Enterprises, Inc newest puzzle, *Intarsia*. Test your knowledge and abilities to calculate the number of possible arrangements of the 32 tiles. The first correct answer will win one of our unique puzzles. Competition will begin on Monday at 12:15 p.m. and will continue until there is a winner!

✱ Math Alive and Applied, Booth 705

Raffle: Come visit Math Alive and Applied to enter to win a raffle for a US\$100 cash prize. This raffle will open Monday at 12:15 p.m. and the winner will be chosen on Wednesday at 5:00 p.m.

Join us for the
Grand Opening of the
Joint Mathematics
Meetings Exhibits on
Monday at 12:15 p.m.
for prizes
and giveaways!

✱ **Mathematical Association of America, Booth 900-913**

Book Signings: *Proof and Other Dilemmas: Mathematics and Philosophy* by **Bonnie Gold** and **Roger Simons**, on Monday from 4:15 p.m. to 5:00 p.m.; *Biscuits of Number Theory* by **Art Benjamin** and **Bud Brown**, on Tuesday from 4:15 p.m. to 5:00 p.m.; *A Guide to Complex Variables* by **Steven Krantz**, on Wednesday, from 4:15 p.m. to 5:00 p.m.

Drawings: On Tuesday stop by the MAA booth and enter to win Spy Museum tickets at a time to be determined. On Wednesday stop by the MAA booth and enter to win a gift basket, a free MAA Membership, or the grand prize of a personalized brick for the Carriage House!

✱ **National Security Agency, Booth 104, 106**

Raffle: The National Security Agency will be raffling off NSA clocks! Visit booth 104 and 106 to enter to win one per day for each day the Exhibits are open. Winners do not need to be present during the drawing.

✱ **Princeton University Press, Booth 500**

Meet and Greet: Princeton University Press will be hosting a variety of author appearances throughout the four days of the Joint Mathematics Meetings. Stop by for a full listing and schedule of dates and times.

✱ **SAGE Free Open Source Math Software, Booth 715**

Raffle: Starting Monday, stop by the The SAGE Project booth and enter to win a free raffle for a variety of SAGE-themed items. Drawings for these prizes will be held Wednesday at 4:30 p.m..

✱ **Springer, Booth 205-213**

Daily Raffles: Stop by the Springer Booth to sign up for SpringerAlerts and, not only will you receive a free gift, but you will also be automatically entered to win an iPod Nano! The winner will be announced at the close of Exhibits on Thursday. The winner will be notified at a later date.

Book Signing: *Buildings: Theory and Applications* by **Ken Brown** and **Peter Abramenko**. Peter will be available to sign your copy. *An Introduction to Mathematical Cryptography* by **Jeffery Hoffstein**, **Jill Pipher** and **J. H. Silverman** will be available to sign your copy. Dates and times will be announced during the Grand Opening!

✱ **xyAlgebra, Booth 113**

Raffle: xyAlgebra will be raffling off a USB flash Drive. Stop by booth 113 and leave either your business card or your email address to enter. The winner will be announced Thursday at the close of Exhibits. Participants do not need to be present to win.

Demonstration: Visit the xyAlgebra booth for a free algebra tutoring and practice program demonstration

✱ **Ymir, Inc-The Ultimate Puzzle, Booth 600**

Competition: Stop by The Ultimate Puzzle, booth 600 and try to solve the Puzzle in 5 minutes or less!! All winners will receive their very own Puzzle, a value of US\$25.00. This competition will be on going for all Exhibit hours.

**Marriott Wardman Park
Exhibition Level
(one floor beneath lobby)**

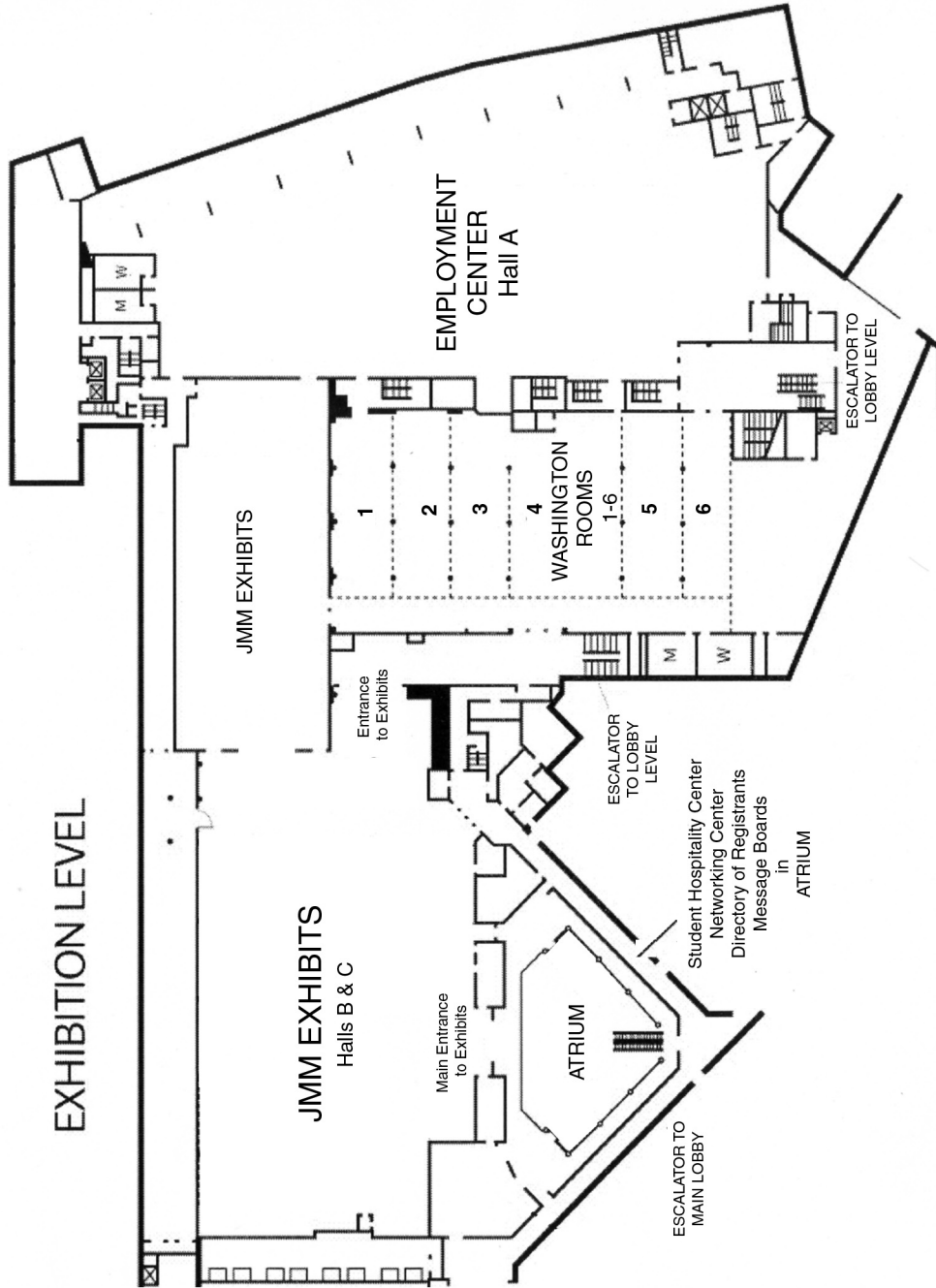

Marriott Wardman Park Lobby Level

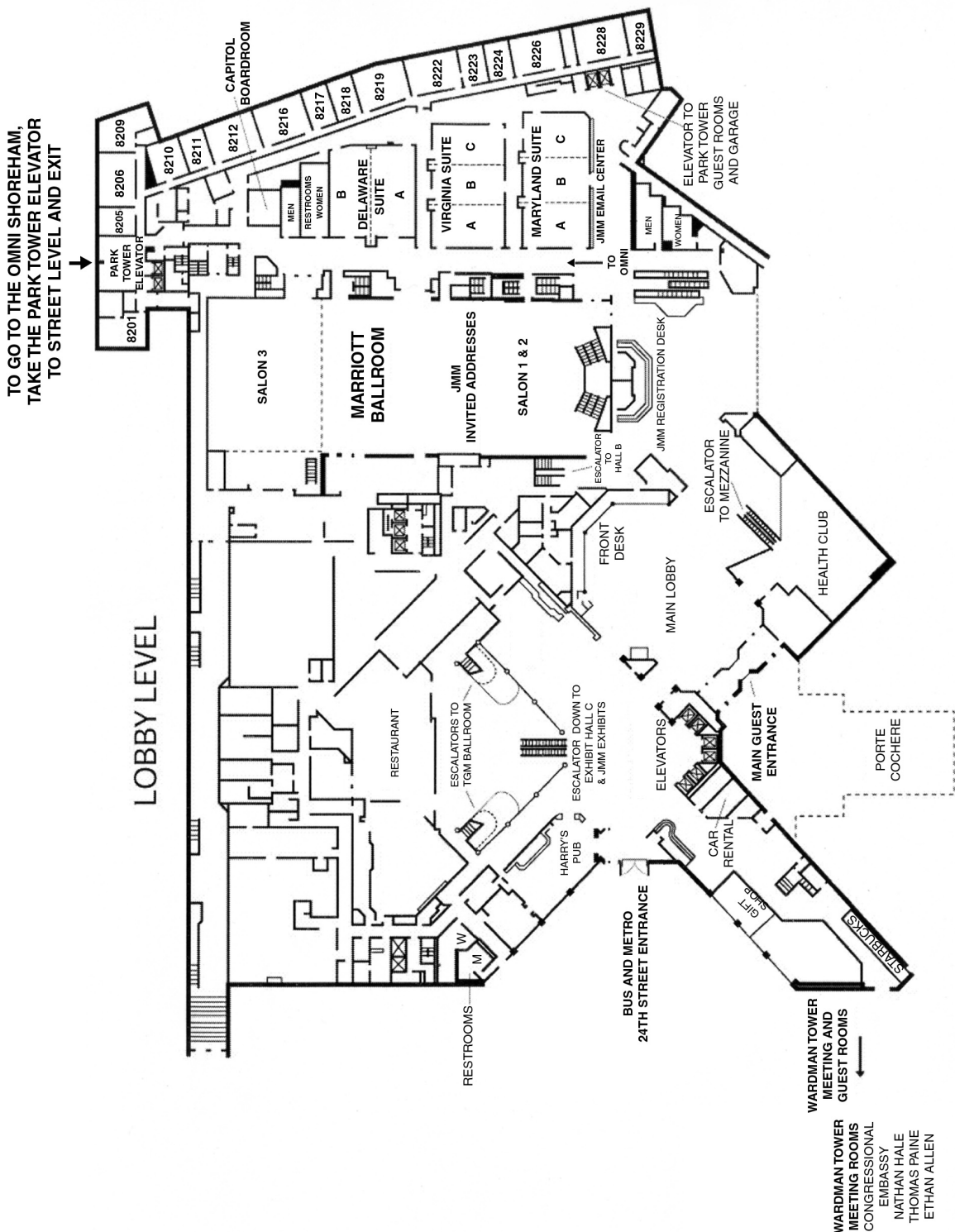

Marriott Wardman Park Mezzanine Level

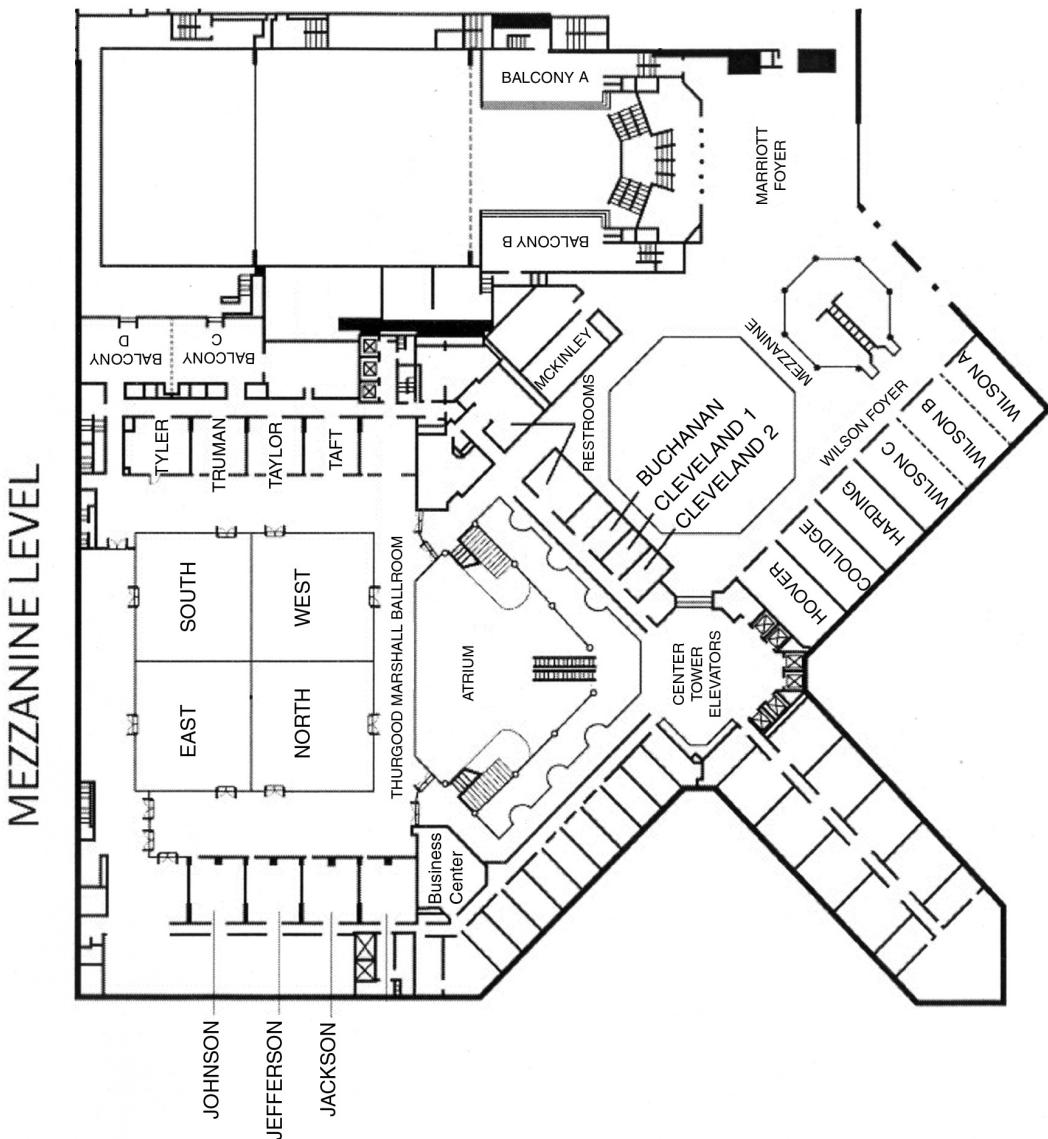

Omni Shoreham Lobby Level

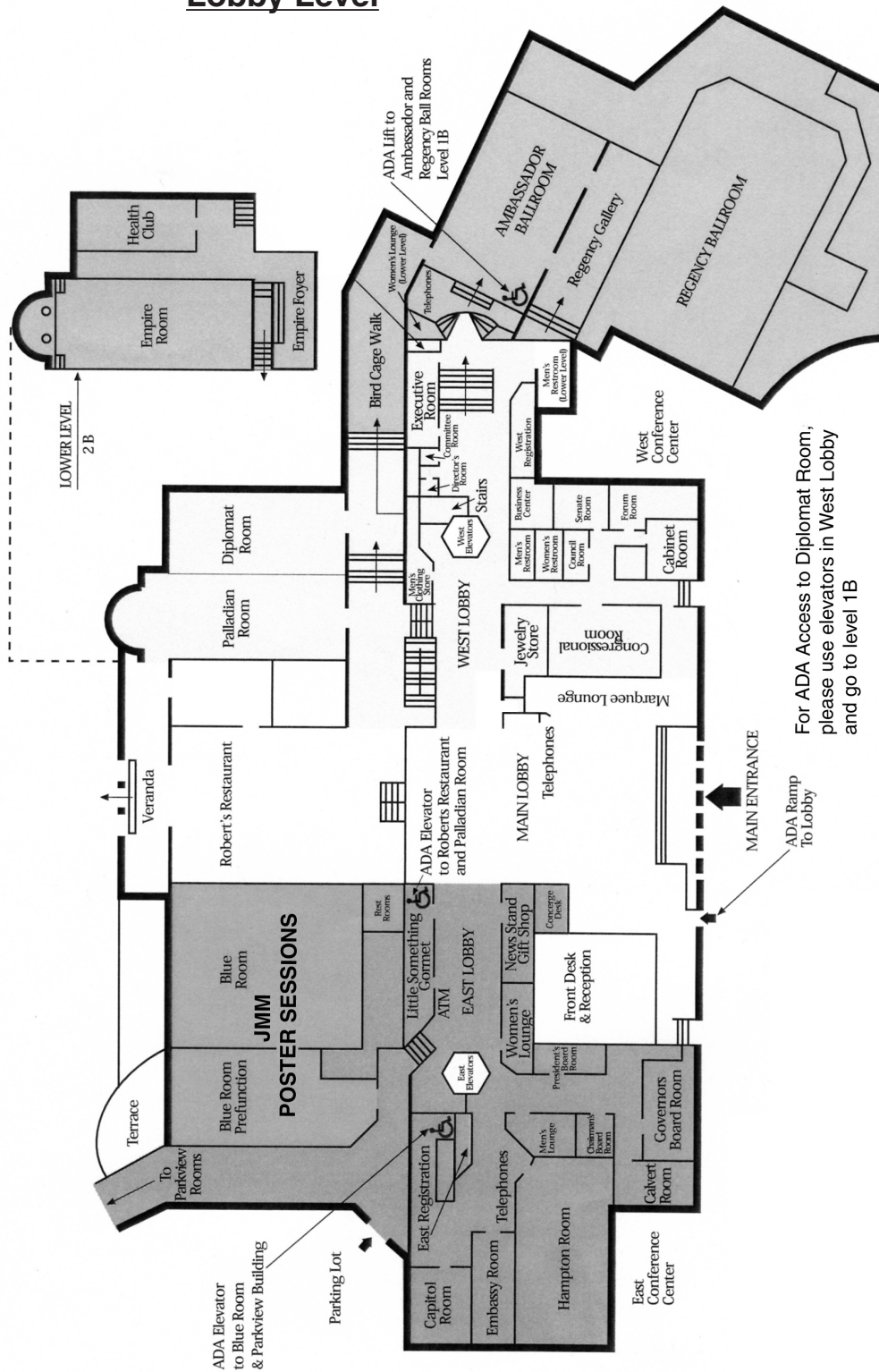

For ADA Access to Diplomat Room,
please use elevators in West Lobby
and go to level 1B

For ADA Access to the Empire room
and Health Club, please use elevators in
the West Lobby and go to level 2B